

Starsurfer

GXY935



Item no. GXY935012-01

General Product Information

Dimensions LxWxH	82x167x56 cm
Age group	6+
Play capacity (users)	2
Colour options	 



The Starsurfer is an awesome play event for exploring and developing balance and coordination skills. It will attract tweens to play again and again, thanks to its multi-functionality. The sense of balance is fundamental to all other motor skills and the rocking platform has space for individuals or groups rocking together. The Starsurfer is a

multi-functional seat, inviting seated, lying or standing children. This makes it an efficient and fun trainer of cooperation, negotiation and turn-taking. These social skills are hard to teach. But they come easy when playing on the Starsurfer.



Data is subject to change without prior notice.

Starsurfer

GXY935



Rocking together

Social-Emotional: the possibility of rocking two together trains cooperation skills and consideration of others.



Movable desk

Physical: facilitates standing, sitting and lying, which supports people with disabilities. Trains balance and sense of space when children are standing, using leg and core muscles. **Social-Emotional:** point for gathering. Supports teamwork and socializing when children are rocking together. Inclusive.

Starsurfer

GXY935



The steel surfaces of GALAXY are hot-dip galvanised inside and outside with lead-free zinc. The galvanisation has excellent corrosion resistance and requires low maintenance.

Starsurfer is made from medium-density PE, which has excellent impact strength and is suitable for hotter climates. The textured surface provides a slip-resistant platform; making it safe for all users.

The rocking movement over two axes is made by heavy duty scaled ROSTA torsion spring element. The two ROSTA elements are noise-free and are maintenance-free.

Item no. GXY935012-01

Installation Information

Max. fall height	70 cm
Safety surfacing area	14.6 m ²
Total installation time	3.2
Excavation volume	0.50 m ³
Concrete volume	0.00 m ³
Footing depth (standard)	45 cm
Shipment weight	71 kg
Anchoring options	In-ground ✓ Surface ✓

Warranty Information

Hollow PE parts	10 years
Galvanised Steel	Lifetime
Spare Parts Guarantee	10 years



Sustainability Data

GXY935



Cradle to Gate A1-A3	Total CO ₂ emission	CO ₂ e/kg	Recycled materials
	kg CO ₂ e	kg CO ₂ e/kg	%
GXY935012-01	200.71	3.03	31.81

The overall framework applied for these factors is the Environmental Product Declaration (EPD), which quantifies "environmental information on the life cycle of a product and enable comparisons between products fulfilling the same function" (ISO, 2006). This follows the structure and applies a Life-Cycle Assessment approach to the entire Product stage from raw material through manufacturing (A1-A3))

Kompan A/S
 C.F. Tietgens Boulevard 32C
 DK-5220 Odense SØ
 Denmark



Verification of CO₂ calculation of: Freestanding play equipment



Data version no. 2023-10-05

The CO₂ calculation and data are in compliance with the principles of a carbon footprint impact according to the GHG protocol (Greenhouse Gas Protocol), Scope 3, cradle to gate related to all individual components in the product category: "Freestanding play equipment" represented by item no.: GXY916012-3417.

(Scope 3 emissions include emission sources in the upstream and downstream value chain).

Date: 30. October 2023 | Valid until: 30. October 2025

Verified by:

Julie Marie Vejsgaard Larsen, LCA & EPD Consultant

Verification based on report: Validation of CO₂ calculation of 9 categories of Kompan product line, version 1.0, prepared by: Bureau Veritas HSE, Denmark: Julie M. V. Larsen.

Publication date: 30. October 2023

By Bureau Veritas HSE
 www.bureauveritas.dk
 +45 7731 1000



Starsurfer

GXY935

* Max fall height | ** Total height | *** Safety surfacing area

* Max fall height | ** Total height

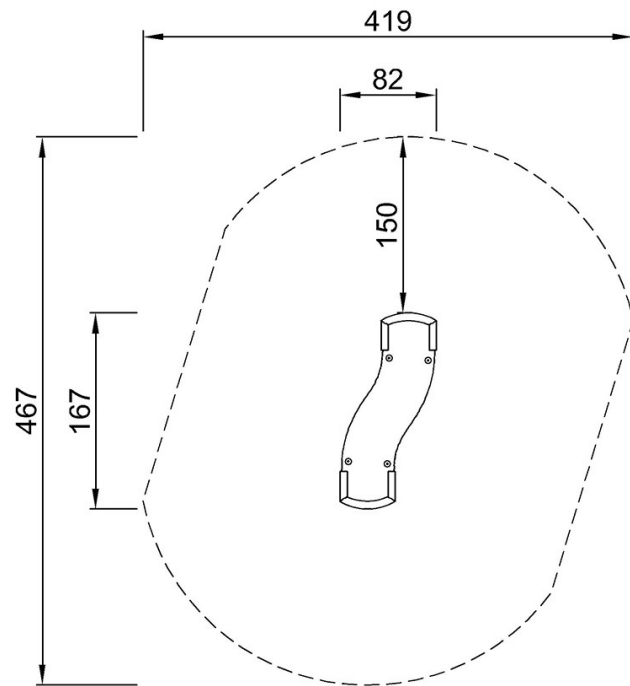

GXY935012
*70cm
**56cm
***14.6m²

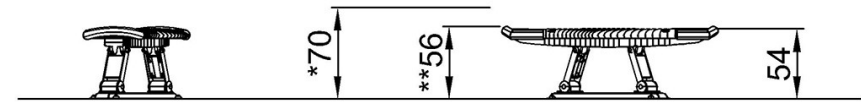

GXY935012

[Click to see TOP VIEW](#)

[Click to see SIDE VIEW](#)