

Waterlilies Balance Posts - 5 pcs

NRO820



Item no. NRO820-0601	
General Product Information	
Dimensions LxWxH	7'1"x3'6"x1'1"
Age group	2 - 12
Play capacity (users)	2
Color options	



The Water Lilies Balance Posts appeal to children, and encourage physical make believe games with rules, for example, pretending the ground is water, and trying to stay out of the water. The Water Lilies invite jumping or balancing from one to the next. They can also be used as individual seats and are perfect for group conversation. The Water Lilies support

children who are less confident, thanks to their width. When balancing from water lily to water lily, children train their proprioception and sense of balance. Balance and proprioception are fundamental skills for confidently managing the body in its surroundings. This is important for instance when navigating street traffic safely. Crossing the Water Lilies with friends

trains turn-taking and negotiation. These are important social-emotional skills that are basic for the ability to form friendship and relate to peers.

Waterlilies Balance Posts - 5 pcs

NRO820



Balance posts

Physical: sense of balance is trained, and bone density built when jumping between and off the pods. **Social-Emotional:** turn-taking and cooperation as well as room for a seated rest with friends.



Waterlilies Balance Posts - 5 pcs

NRO820



All Organic Robinia products by KOMPAN are made of Robinia wood from sustainable European sources. On request it can be supplied as FSC® Certified (FSC® C004450).

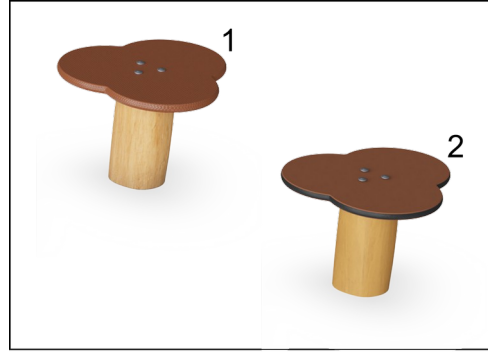

The steps are available in two versions. Either 8.46 in. thick plywood made from alder and pinewood, with both sides covered with two layers of phenolic film with anti-slip net pattern or 2) EcoCore HDPE panels.



The Robinia wood can be supplied as untreated raw wood or painted with a brown colored transparent pigment that maintains the golden wood color of the wood.

Item no. NRO820-0601	
Installation Information	
Max. fall height	1'1"
Safety surfacing area	237ft ²
Total installation time	2.4
Excavation volume	0.27yd ³
Concrete volume	0.1yd ³
Footing depth (standard)	2'0"
Shipment weight	196lbs
Anchoring options	In-ground <input checked="" type="checkbox"/> Surface <input checked="" type="checkbox"/>
Warranty Information	
Robinia Wood	10 Years
Spare Parts Availability	10 Years

Elevated activities 0	Accessible elevated activities	Accessible ground level activities	Accessible ground level play types
Present	0	1	1
Required	0	1	1

Sustainability Data

NRO820



Cradle to Gate A1-A3	Total CO ₂ emission	CO ₂ e/kg	Recycled materials
	kg CO ₂ e	kg CO ₂ e/kg	%
NRO820-0601	9.64	0.12	0.25

The overall framework applied for these factors is the Environmental Product Declaration (EPD), which quantifies "environmental information on the life cycle of a product and enable comparisons between products fulfilling the same function" (ISO, 2006). This follows the structure and applies a Life-Cycle Assessment approach to the entire Product stage from raw material through manufacturing (A1-A3))

Kompan A/S
 C.F. Tietgens Boulevard 32C
 DK-5220 Odense SØ
 Denmark



Verification of CO₂ calculation of: Nature play



Data version no. 2023-10-05

The CO₂ calculation and data are in compliance with the principles of a carbon footprint impact according to the GHG protocol (Greenhouse Gas Protocol), Scope 3, cradle to gate related to all individual components in the product category: "Nature play" represented by item no.: NRO409-0621.

(Scope 3 emissions include emission sources in the upstream and downstream value chain).

Date: 30. October 2023 | Valid until: 30. October 2025

Verified by:

Julie Marie Vejsgaard Larsen, LCA & EPD Consultant

Verification based on report: Validation of CO₂ calculation of 9 categories of Kompan product line, version 1.0, prepared by: Bureau Veritas HSE, Denmark: Julie M. V. Larsen.

Publication date: 30. October 2023

By Bureau Veritas HSE
 www.bureauveritas.dk
 +45 7731 1000



Waterlilies Balance Posts - 5 pcs

NRO820

* Max fall height | ** Total height | *** Safety surfacing area

* Max fall height | ** Total height

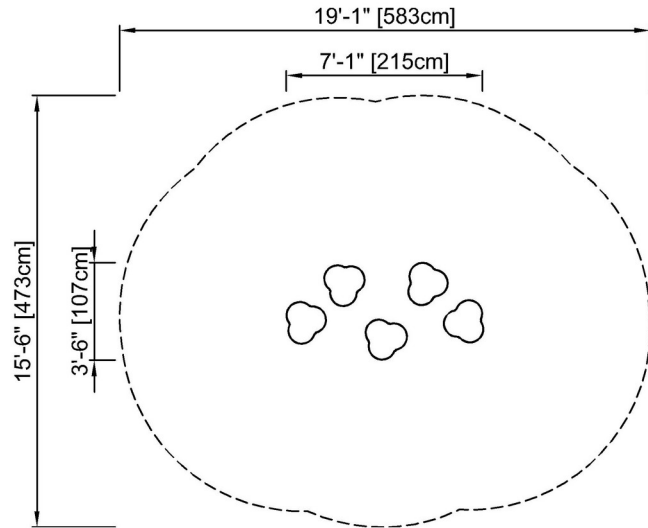

NRO820
* 1'-1" / 32cm
** 1'-1" / 32cm
***236.8ft² / 22m²

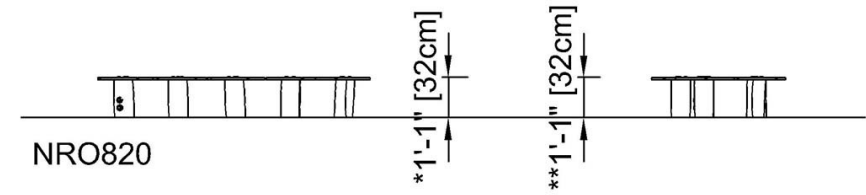

[Click to see TOP VIEW](#)

[Click to see SIDE VIEW](#)