

# Percussion Music Panel

NRO602



Item no. NRO602-1001

## General Product Information

Dimensions LxWxH	170x46x78 cm
Age group	2 - 5
Play capacity (users)	3
Colour options	



The Robinia Percussion Music Panel is an immense play invitation for children: the variation in drumming sounds and the tonal response to movements attracting children again and again. The drums can be played alone or together. There is room for many users to congregate around the differently textured and sounding drums. This encourages

social interaction and co-creation when drumming rhythms and singing along. It also stimulates cognition and creativity as children create rules and rhythms together or individually. The percussion drum additionally has different sounding divisions. For older children and adults this creates variations in tonality and sound patterns. Drumming and

creating rhythms on the drums stimulate the child's ability to understand cause and effect and leave a mark on their play, both important for cognitive as well as creative skills.

# Percussion Music Panel

NRO602



## Percussion

**Social-Emotional:** cooperative play and co-creation when playing from both sides.

**Cognitive:** understanding cause and effect when figuring out different sounding areas of surface, and practicing with rhythm, that is essential for pre-reading skills. **Creative:** creating, combining and leaving a mark of different sounds.



## Two sides

**Social-Emotional:** invites cooperation and communication. The low height and the transparency of the panel makes interaction possible between the two sides.



## Drums

**Social-Emotional:** cooperation and co-creation, parallel and group play. **Cognitive:** cause and effect understanding when creating sounds, supporting a sense of rhythm, that is essential for pre-reading skills. **Creative:** creating and leaving a mark with sound.

# Percussion Music Panel

NRO602



All Organic Robinia products by KOMPAN are made of Robinia wood from sustainable European sources. On request it can be supplied as FSC® Certified (FSC® C004450).



The paint used for coloured components is water based environmental friendly with excellent UV resistance. The paint is in compliance with EN 71 Part 3.



Play activities in very strong materials: HDPE-plate with HDPE-clock and hands in conveyer belt rubber, bell in pressed aluminium. Mirror in plexi-glass with a high impact resistant.



All rubber activities/components are made of conveyer belt rubber that makes it extremely weather resistant and long lasting.

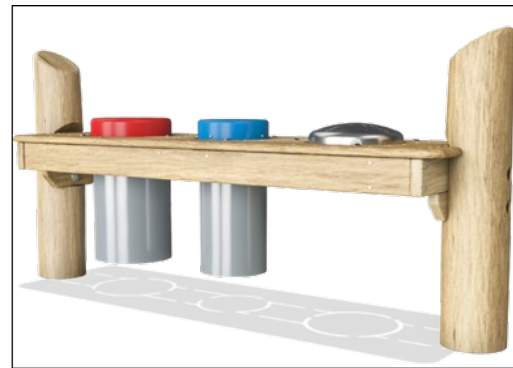

The percussion panel consist of 2 Conga Drums with PP tubes and top in coloured ABS. Babel drum in stainless steel 316L.

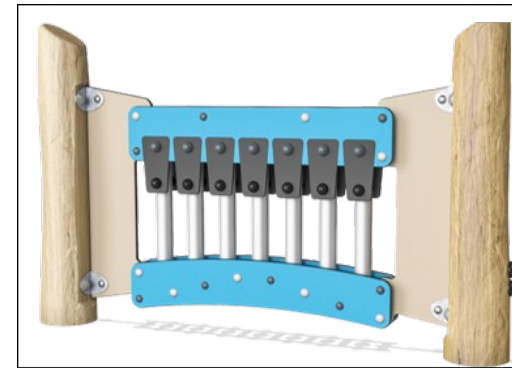

The Xylofon music panel consist of HDPE - material in 19mm EcoCore™. EcoCore™ is a highly durable, ecofriendly material. The pipes are made of die-cast aluminium specifically alloyed for outdoor environments.

Item no. NRO602-1001

## Installation Information

Max. fall height	0 cm
Safety surfacing area	0.0 m²
Total installation time	3.7
Excavation volume	0.25 m³
Concrete volume	0.00 m³
Footing depth (standard)	100 cm
Shipment weight	117 kg
Anchoring options	In-ground ✓ Surface ✓

## Warranty Information

Robinia wood	15 years
Spare parts guaranteed	10 years
Stainless steel components	Lifetime
Stainless steel components	Lifetime

Elevated activities 0	Accessible elevated activities	Accessible ground level activities	Accessible ground level play types
Present	0	1	1
Required	0	1	1

**CSA  
Z614**  
compliant

# Sustainability Data

NRO602



Cradle to Gate A1-A3	Total CO <sub>2</sub> emission	CO <sub>2</sub> e/kg	Recycled materials
	kg CO <sub>2</sub> e	kg CO <sub>2</sub> e/kg	%
<b>NRO602-1001</b>	31.32	0.34	2.61

The overall framework applied for these factors is the Environmental Product Declaration (EPD), which quantifies "environmental information on the life cycle of a product and enable comparisons between products fulfilling the same function" (ISO, 2006). This follows the structure and applies a Life-Cycle Assessment approach to the entire Product stage from raw material through manufacturing (A1-A3))

**Kompan A/S**  
C.F. Tietgens Boulevard 32C  
DK-5220 Odense SØ  
Denmark

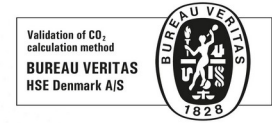

## Verification of CO<sub>2</sub> calculation of: Nature play



Data version no. 2023-10-05

The CO<sub>2</sub> calculation and data are in compliance with the principles of a carbon footprint impact according to the GHG protocol (Greenhouse Gas Protocol), Scope 3, cradle to gate related to all individual components in the product category: "Nature play" represented by item no.: NRO409-0621.

(Scope 3 emissions include emission sources in the upstream and downstream value chain).

**Date: 30. October 2023 | Valid until: 30. October 2025**

Verified by:

Julie Marie Vejsgaard Larsen, LCA & EPD Consultant

Verification based on report: Validation of CO<sub>2</sub> calculation of 9 categories of Kompan product line, version 1.0, prepared by: Bureau Veritas HSE, Denmark: Julie M. V. Larsen.

**Publication date: 30. October 2023**

By Bureau Veritas HSE  
www.bureauveritas.dk  
+45 7731 1000



# Percussion Music Panel

NRO602

\* Max fall height | \*\* Total height | \*\*\* Safety surfacing area

\* Max fall height | \*\* Total height

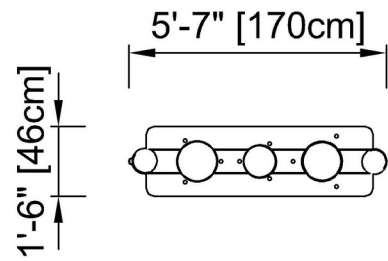

NRO602  
\*\* 2'-7" / 78cm

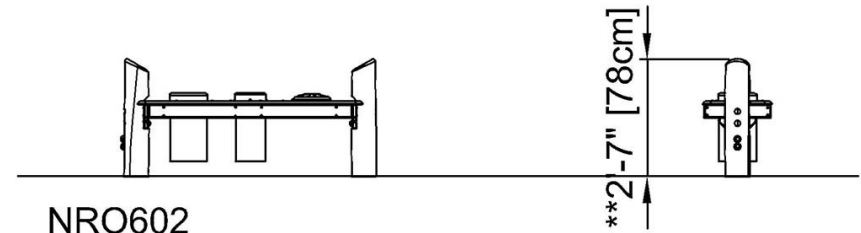

NRO602

[Click to see TOP VIEW](#)

[Click to see SIDE VIEW](#)