

# Outdoor Timer

PCM201

**KOMPAN**  
Let's play



Item nummer PCM201-0901

## Algemene Product Informatie

Afmetingen LxBxH	44x23x127 cm
Leeftijdsgroep	5+
Speelcapaciteit	4
Kleuropties	●



De Outdoor Timer heeft een onweerstaanbare aantrekkingskracht op kinderen van alle leeftijden: zodra ze een knopje indrukken, horen ze aan het geluid dat het aftellen is begonnen. Ze krijgen geen genoeg van de timer want niks is zo geweldig als je eigen prestaties bijhouden en vergelijken met die van anderen. De timer is ontwikkeld op basis van

onderzoek van het KOMPAN Play Institute. De resultaten wezen uit dat oudere kinderen het megaleuk vinden om tegen de klok te racen, met een timer die precies bijhoudt hoe snel ze zijn en wie de snelste is. Om de beurt gaan is veel leuker en gemakkelijker met een timer die precies kan worden afgesteld op 10 of 30 seconden, en 2 of 5 minuten. De timer

verhoogt de speelintensiteit, stimuleert samenwerking en leert kinderen om rekening te houden met anderen.



# Outdoor Timer

PCM201

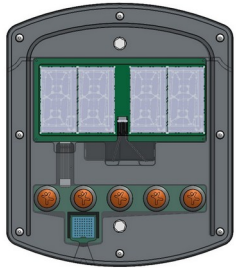

The reflective LCD display has four digits of 100mm height, with excellent outdoor visibility and a wide viewing angle. An LCD display has a low energy consumption, It is powered by 8 replaceable AA batteries with a lifespan of more than 2 years.

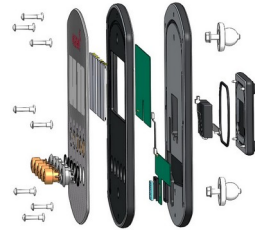

Front panels are made of UV-stabilized Polycarbonate. The UV-stabilization prevents the Transparent panels in being yellow over time and ensures the mechanical performances. The graphic prints are added by a unique multi-layer print process where the inner layer is the image and outer transparent layer functions as protection. The lacquer is water-based, and UV stabilized to prevent fading.



The push buttons and the housing for the push buttons are made from Polyamide (PA6). The buttons contain a magnet which activates a contactless reed switch when the buttons are pushed. This ensures high durability of the system.



The connectors are made of die-cast aluminum specially alloyed for outdoor environments and with a lead content below 100ppm. The connectors are attached to the posts by stainless steel screws and well protected against corrosion by special designed zinc washers. Extremely strong and no change of corrosion.

The loudspeaker is a piezoelectric speaker with a sound level of 90dB, and low power consumption. As power source we use eight standard AA 1,5V replaceable batteries with a capacity of 2.95Ah. The expected lifetime of the batteries is two years, depending on usage. It is recommended to inspect the batteries yearly. The batteries are placed in two sealed battery boxes with a protection class of IP65.



Steel posts are made of Ø101,6 x 2,0mm pre-galvanized steel tube. The posts are powder coated. Tops of posts are sealed with plastic caps (PA6). Footings for surface installation are manufactured from Carbon steel with hot-dip galvanized surface according to ISO1461.

Item nummer PCM201-0901	
Installatie informatie	
Max. valhoogte	0 cm
Veiligheidszone	9,6 m <sup>2</sup>
Totale installatietijd	2,4
Graafwerk (vol.)	0,03 m <sup>3</sup>
Benodigd beton	0,01 m <sup>3</sup>
Verankeringsdiepte	85 cm
Verzendingsgewicht	37 kg
Verankeringsopties	In-ground ✓ Oppervlak ✓
Garantie informatie	
Polycarbonate PC panels	10 jaar
Staander	10 jaar
Gegarandeerde reserveonderdelen	10 jaar



# Sustainability Data

PCM201



Cradle to Gate A1-A3	Total CO <sub>2</sub> emission	CO <sub>2</sub> e/kg	Recycled materials
	kg CO <sub>2</sub> e	kg CO <sub>2</sub> e/kg	%
PCM201-0901	65,32	2,85	59,16

The overall framework applied for these factors is the Environmental Product Declaration (EPD), which quantifies "environmental information on the life cycle of a product and enable comparisons between products fulfilling the same function" (ISO, 2006). This follows the structure and applies a Life-Cycle Assessment approach to the entire Product stage from raw material through manufacturing (A1-A3))

**Kompan A/S**  
 C.F. Tietgens Boulevard 32C  
 DK-5220 Odense SØ  
 Denmark



## Verification of CO<sub>2</sub> calculation of: Park



Data version no. 2023-10-05

The CO<sub>2</sub> calculation and data are in compliance with the principles of a carbon footprint impact according to the GHG protocol (Greenhouse Gas Protocol), Scope 3, cradle to gate related to all individual components in the product category: "Park" represented by item no.: PAR4070-0001.

(Scope 3 emissions include emission sources in the upstream and downstream value chain).

**Date: 30. October 2023 | Valid until: 30. October 2025**

**Verified by:**

Julie Marie Vejsgaard Larsen, LCA & EPD Consultant

Verification based on report: Validation of CO<sub>2</sub> calculation of 9 categories of Kompan product line, version 1.0, prepared by: Bureau Veritas HSE, Denmark: Julie M. V. Larsen.

**Publication date: 30. October 2023**

By Bureau Veritas HSE  
 www.bureauveritas.dk  
 +45 7731 1000



# Outdoor Timer

PCM201

Max. valhoogte | Totale Hoogte | Veiligheidszone

Max. valhoogte | Totale Hoogte

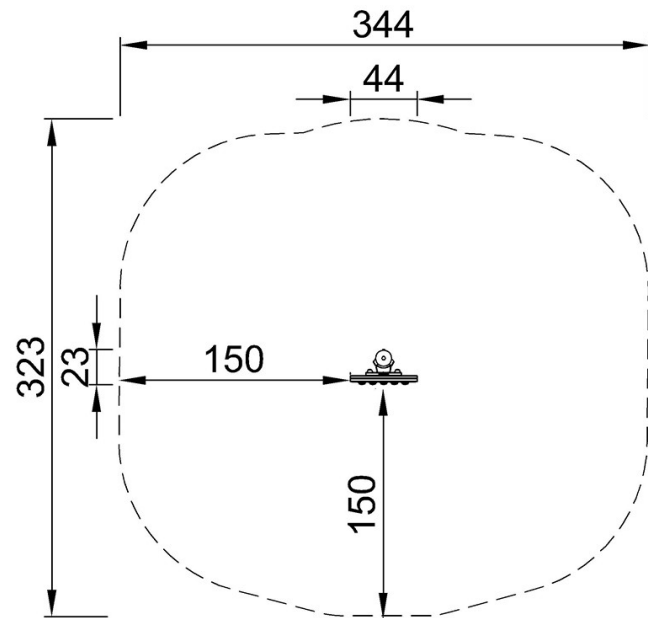

PCM201  
\*\*127cm  
\*\*\*9.6m<sup>2</sup>

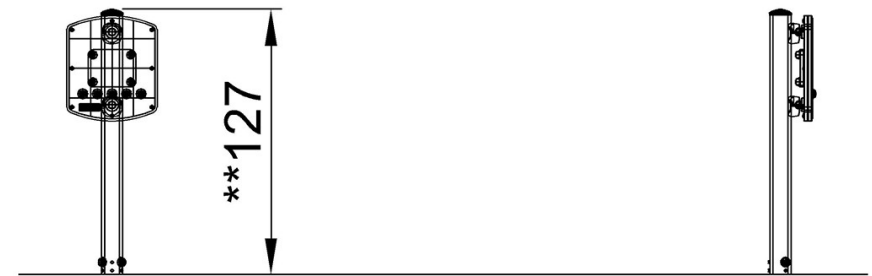

PCM201

[Bekijk BOVENAANZICHT](#)

[Bekijk ZIJAAANZICHT](#)