

Overhead Ladder

FPW205



| | |
|------------------------------------|----------------|
| Item no. FPW20500-0900 | |
| General Product Information | |
| Dimensions LxWxH | 228x119x240 cm |
| Age group | 8+ |
| Play capacity (users) | 2 |
| Color options | |



The overhead ladder, also known as the monkey bar, may be the most famous of all obstacle course elements. The goal is to get to the other side without using your feet. This overhead ladder is wide and high to ensure anyone can hang and move freely. To make sure that everyone can reach the overhead ladder there are 4 stepping pods at different

heights

Overhead Ladder

FPW205



Post are made of $\text{Ø}101.6 \times 2\text{mm}$, pre-galvanized carbon steel and powder coated, a great protection to all conditions.



The connectors are made of die-cast aluminium, specially alloyed for the outdoor environments and heavy usage. The screws attaching the connectors are stainless steel and protected by zinc washers.



The Four-steps are 900x280mm and have a height of 171mm.

Item no. FPW20500-0900

Installation Information

| | |
|--------------------------|---------------------|
| Max. fall height | 233 cm |
| Safety surfacing area | 29.5 m ² |
| Total installation time | 3.4 |
| Excavation volume | 0.25 m ³ |
| Concrete volume | 0.14 m ³ |
| Footing depth (standard) | 90 cm |
| Shipment weight | 159 kg |
| Anchoring options | |



Sustainability Data

FPW205



| Cradle to Gate A1-A3 | Total CO ₂ emission | CO ₂ e/kg | Recycled materials |
|----------------------|--------------------------------|-------------------------|--------------------|
| | kg CO ₂ e | kg CO ₂ e/kg | % |
| FPW20500-0900 | 330.60 | 3.37 | 48.70 |

The overall framework applied for these factors is the Environmental Product Declaration (EPD), which quantifies "environmental information on the life cycle of a product and enable comparisons between products fulfilling the same function" (ISO, 2006). This follows the structure and applies a Life-Cycle Assessment approach to the entire Product stage from raw material through manufacturing (A1-A3))

Kompan A/S
 C.F. Tietgens Boulevard 32C
 DK-5220 Odense SØ
 Denmark



Verification of CO₂ calculation of: Fitness



Data version no. 2023-10-05

The CO₂ calculation and data are in compliance with the principles of a carbon footprint impact according to the GHG protocol (Greenhouse Gas Protocol), Scope 3, cradle to gate related to all individual components in the product category: "Fitness" represented by item no.: FAZ10100-0900.

(Scope 3 emissions include emission sources in the upstream and downstream value chain).

Date: 30. October 2023 | Valid until: 30. October 2025

Verified by:

Julie Marie Vejsgaard Larsen, LCA & EPD Consultant

Verification based on report: Validation of CO₂ calculation of 9 categories of Kompan product line, version 1.0, prepared by: Bureau Veritas HSE, Denmark: Julie M. V. Larsen.

Publication date: 30. October 2023

By Bureau Veritas HSE
 www.bureauveritas.dk
 +45 7731 1000



Overhead Ladder

FPW205

* Max fall height | ** Total height | *** Safety surfacing area

* Max fall height | ** Total height

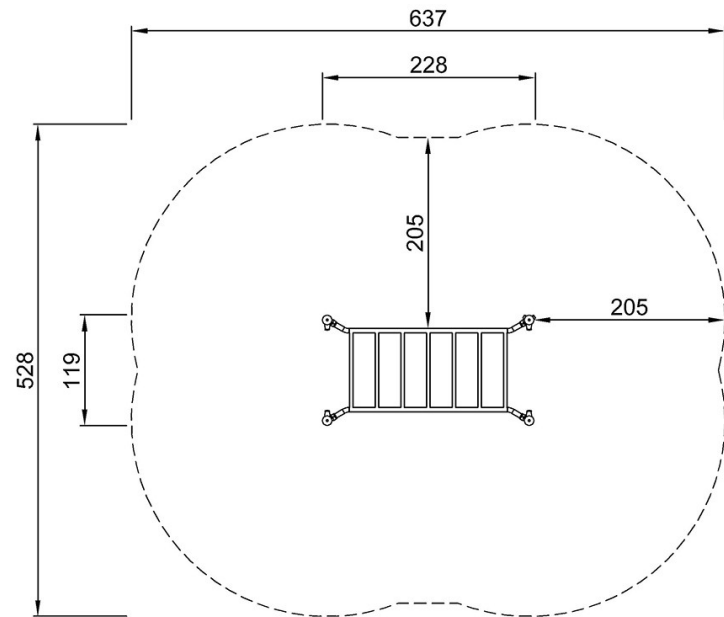

FPW20500
*233cm
**240cm
***29.5m²

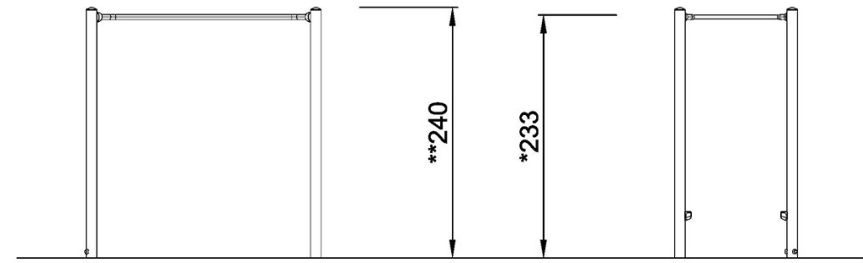

FPW20500
1:100

[Click to see TOP VIEW](#)

[Click to see SIDE VIEW](#)