

# Wave Stepper

CRP201201



Item no. CRP201201-0401	
<b>General Product Information</b>	
Dimensions LxWxH	290x65x29 cm
Age group	2+
Play capacity (users)	4
Color options	



The Wave Stepper is a great balancing quest, attracting children and encouraging them to play again and again. Response to the children's movement provides thrill and develops the cause-and-effect understanding; when I move here, the bridge responds with this movement. When walking or running across the Wave Stepper, the children train

their sense of balance, which is a fundamental motor skill and basic for the development of all other skills. The sense of balance for instance makes it possible for children to sit still and concentrate. When children play together on the Wave Stepper, they develop empathy, turn-taking skills, and consideration. The 360-degree design allows for social interaction for

all at ground level.



Data is subject to change without prior notice.

# Wave Stepper

CRP201201



Corocord membranes consist of friction-proof rubberized material of conveyor belt quality with excellent UV resistance. Tested and compliant with REACH requirements for PAH. Embedded is a four-layered armoring made of woven polyester. The armoring and the two surface layers result in a total thickness of 8 mm.



Panels of 19mm EcoCore™. EcoCore™ is a highly durable, eco friendly material, which is not only recyclable after use, but also consists of material produced from +95% recycled post consumer material from food packing waste.



The two central plates on the Wave Stepper are of made of Ekogrip® panels that consist of a 15mm thick PE base with 3 mm top-layer of soft rubber with a non-skid effect.

Item no. CRP201201-0401

## Installation Information

Max. fall height	28 cm
Safety surfacing area	19.3 m <sup>2</sup>
Total installation time	4.9
Excavation volume	1.73 m <sup>3</sup>
Concrete volume	0.96 m <sup>3</sup>
Footing depth (standard)	90 cm
Shipment weight	132 kg
Anchoring options	



The bushings are made of stainless steel or galvanized steel to ensures excellent shock absorption and durable connections with a high corrosion resistance.



The steel surfaces are hot dip galvanized inside and outside with lead free zinc. The galvanisation has excellent corrosion resistance in outside environments and requires low maintenance.

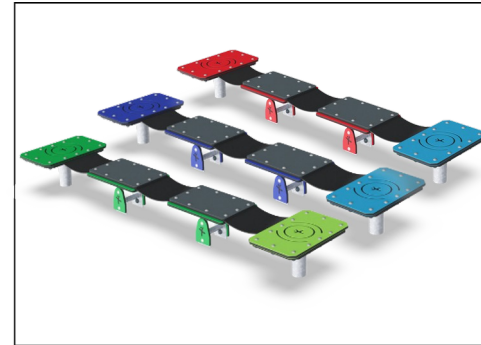

The Wave Stepper comes in three different iconic color concepts. But the Stepper can also be customized to your preferences and personalized with a variety of Kompan colors, for both the base plates and footing.

**EN  
1176**  
compliant

# Sustainability Data

CRP201201

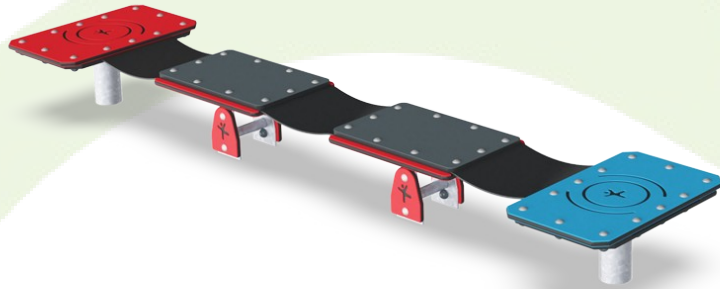

Cradle to Gate A1-A3	Total CO <sub>2</sub> emission	CO <sub>2</sub> e/kg	Recycled materials
	kg CO <sub>2</sub> e	kg CO <sub>2</sub> e/kg	%
<b>CRP201201-0401</b>	233.40	2.33	57.10

The overall framework applied for these factors is the Environmental Product Declaration (EPD), which quantifies "environmental information on the life cycle of a product and enable comparisons between products fulfilling the same function" (ISO, 2006). This follows the structure and applies a Life-Cycle Assessment approach to the entire Product stage from raw material through manufacturing (A1-A3))

**Kompan A/S**  
 C.F. Tietgens Boulevard 32C  
 DK-5220 Odense SØ  
 Denmark



## Verification of CO<sub>2</sub> calculation of: Corocord



Data version no. 2023-10-05

The CO<sub>2</sub> calculation and data are in compliance with the principles of a carbon footprint impact according to the GHG protocol (Greenhouse Gas Protocol), Scope 3, cradle to gate related to all individual components in the product category: "Corocord" represented by item no.: COR314011-1101.

(Scope 3 emissions include emission sources in the upstream and downstream value chain).

**Date: 30. October 2023 | Valid until: 30. October 2025**

Verified by:

Julie Marie Vejsgaard Larsen, LCA & EPD Consultant

Verification based on report: Validation of CO<sub>2</sub> calculation of 9 categories of Kompan product line, version 1.0, prepared by: Bureau Veritas HSE, Denmark: Julie M. V. Larsen.

**Publication date: 30. October 2023**

By Bureau Veritas HSE  
 www.bureauveritas.dk  
 +45 7731 1000



# Wave Stepper

CRP201201

\* Max fall height | \*\* Total height | \*\*\* Safety surfacing area

\* Max fall height | \*\* Total height

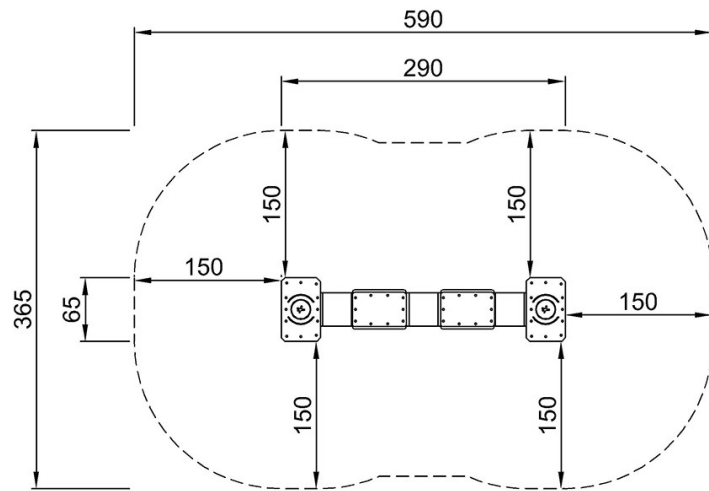

CRP201201  
\*28cm  
\*\*29cm  
\*\*\*19.3m<sup>2</sup>

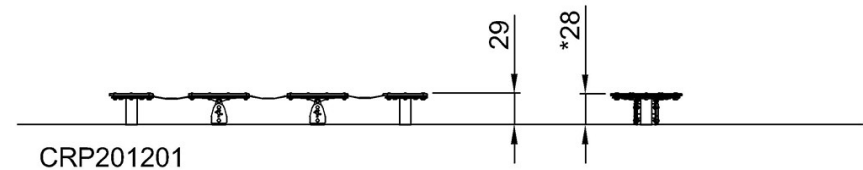

[Click to see TOP VIEW](#)

[Click to see SIDE VIEW](#)