

Truck

M534

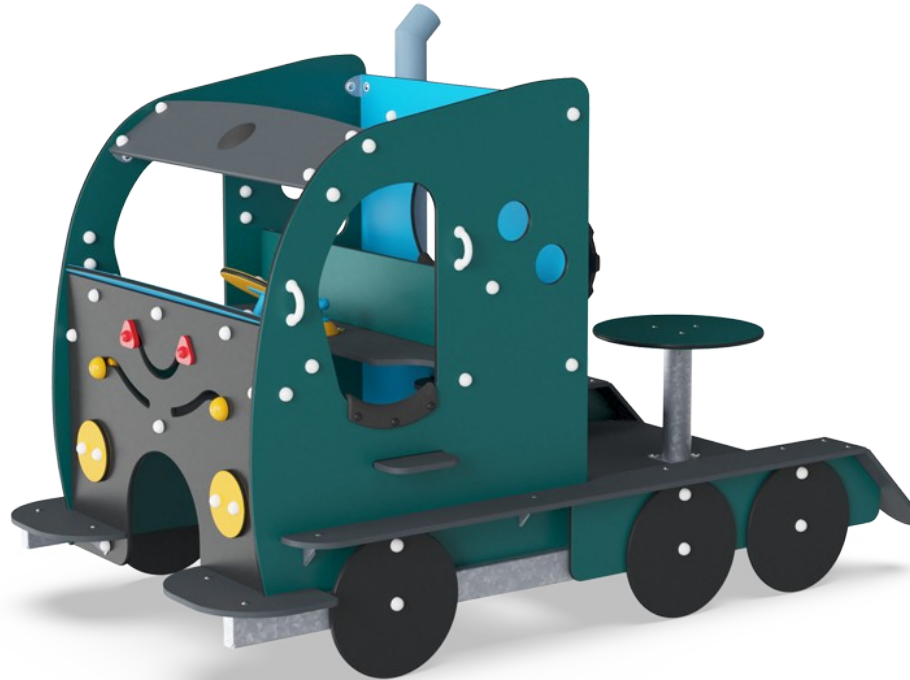

Item no. M53471-3418P

General Product Information

Dimensions LxWxH	5'1"x8'11"x6'3"
Age group	2 - 5
Play capacity (users)	8
Color options	



WOW – a truck! The Truck is a playground hit for all future drivers. With its spacious platforms and dens, it's an experience to explore. Thanks to the side, rear and front openings that allow children to enter from all sides, the driver's compartment stimulates versatile crawling. This trains cross-coordination, which is important for the child's ability to move body sides

independently. That stimulates functions in the brain which are important to future reading skills. The truck's driving compartment has steering wheels and gears and numerous tactile elements. The back of the truck has a black crane hoisting wheel. These elements stimulate cause-and-effect understanding when children play with them. The back is a fine

gathering space with table and sides to sit on. This social space invites children and caregivers alike.

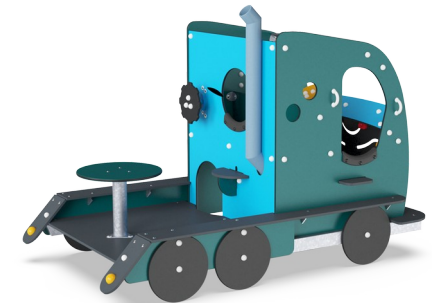

Truck

M534

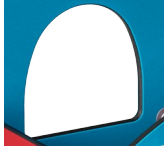

Window

Social-Emotional: invites interaction between sides and cooperative play.



Play sphere

Social-Emotional: can be played from both sides, encouraging cooperation. **Cognitive:** cause and effect understanding. **Creative:** leave a mark and place the spheres at different positions.



Table

Social-Emotional: fine meeting place and a space creator. Sharing and cooperation create a social scenario that supports communication and cooperation.



Theme

Cognitive: suggests a theme and supports dramatic play, which stimulates language and communication skills.



Crawl-through hole

Physical: the hole allows for climbing and crawling through, developing cross coordination, proprioception and spatial awareness. **Social-Emotional:** cooperation and turn-taking when passing one another. **Cognitive:** understanding space, shape and measurements when seeing if the body can fit through the hole.



Turning wheel

Cognitive: the manipulative item stimulates cause and effect understanding.

Truck

M534



Panels of 19mm EcoCore™. EcoCore™ is a highly durable, eco friendly material, which is not only recyclable after use, but also consists of a core produced from 100% recycled material.

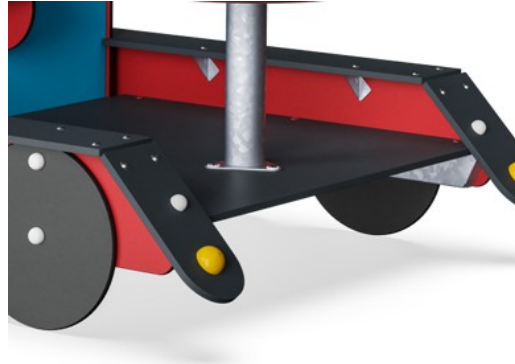

Foot support is made of HPL with a thickness of 17.8mm with a very high wearing strength and a unique KOMPAN non-skid surface texture.



The steel surfaces are hot-dip galvanized inside and outside with lead-free zinc. The galvanization has excellent corrosion resistance in outside environments and requires minimal maintenance.

Item no. M53471-3418P	
Installation Information	
Max. fall height	3'0"
Safety surfacing area	321ft²
Total installation time	12.6
Excavation volume	0.8yd³
Concrete volume	0yd³
Footing depth (standard)	2'1"
Shipment weight	857lbs
Anchoring options	In-ground ✓ Surface ✓
Warranty Information	
EcoCore HDPE	Lifetime
Hot dip galvanized steel	Lifetime
HPL decks	15 Years
PUR components	10 Years
Spare Parts Availability	10 Years



Exhaust pipe is made of polypropylene PP with excellent impact strength and usable within a large temperature span.

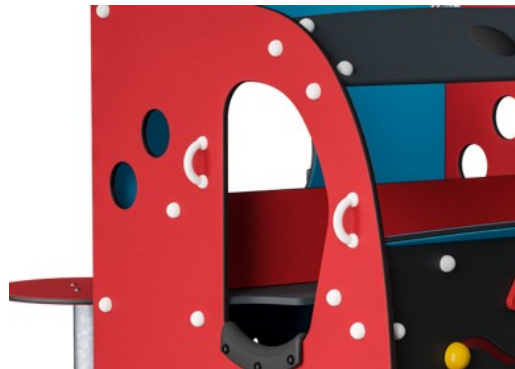

Handholds are made of injection molded high quality nylon (PA6). PA6 has good wearing and impact strength.



KOMPAN GreenLine versions are designed with the most environmentally friendly materials with the lowest possible CO2e emission factor such as EcoCore™ panels of 100% post-consumer recycled ocean waste.

Elevated activities 0	Accessible elevated activities	Accessible ground level activities	Accessible ground level play types
Present	0	1	1
Required	0	1	1



Sustainability Data

M534

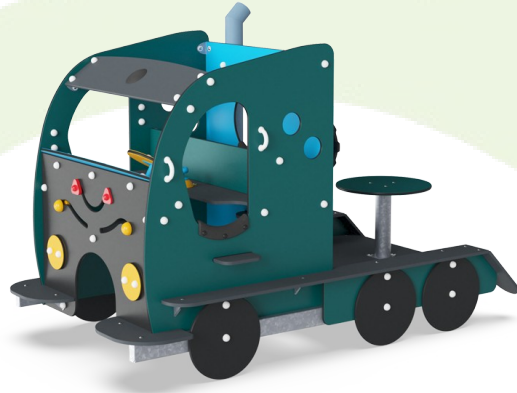

Cradle to Gate A1-A3	Total CO₂ emission	CO₂e/kg	Recycled materials
	kg CO ₂ e	kg CO ₂ e/kg	%
M53471-3418P	586.53	1.73	49.25

The overall framework applied for these factors is the Environmental Product Declaration (EPD), which quantifies "environmental information on the life cycle of a product and enable comparisons between products fulfilling the same function" (ISO, 2006). This follows the structure and applies a Life-Cycle Assessment approach to the entire Product stage from raw material through manufacturing (A1-A3))

Truck

M534

* Max fall height | ** Total height | *** Safety surfacing area

* Max fall height | ** Total height

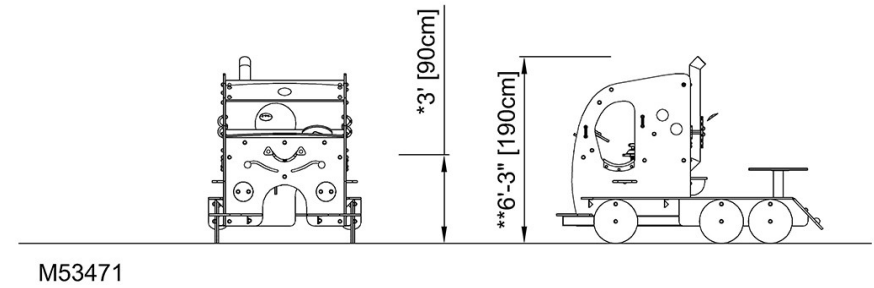
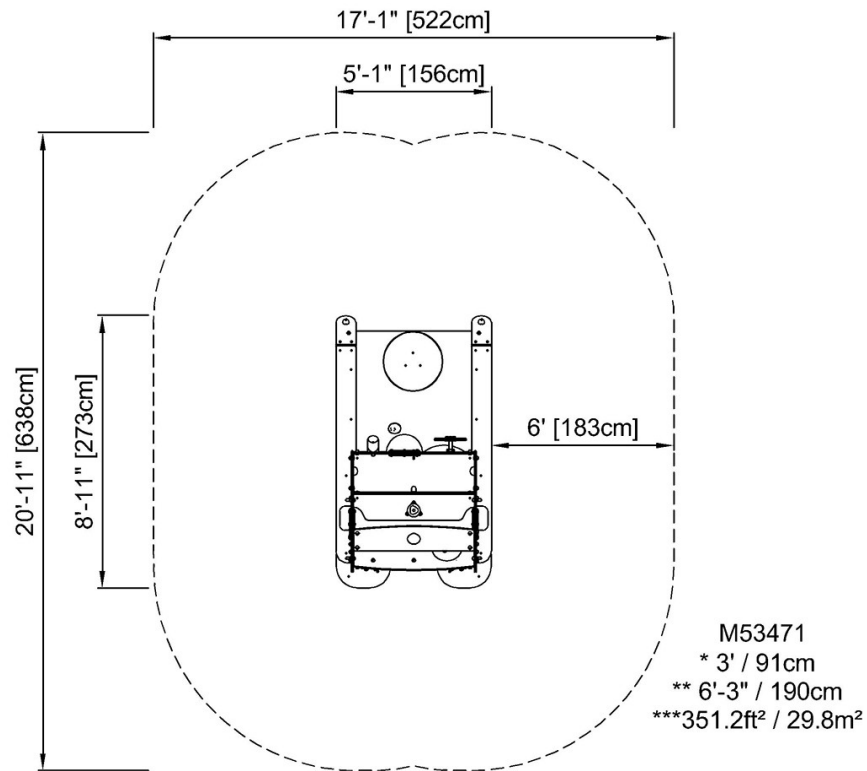

[Click to see TOP VIEW](#)

[Click to see SIDE VIEW](#)