

Wave Stepper

CRP201201

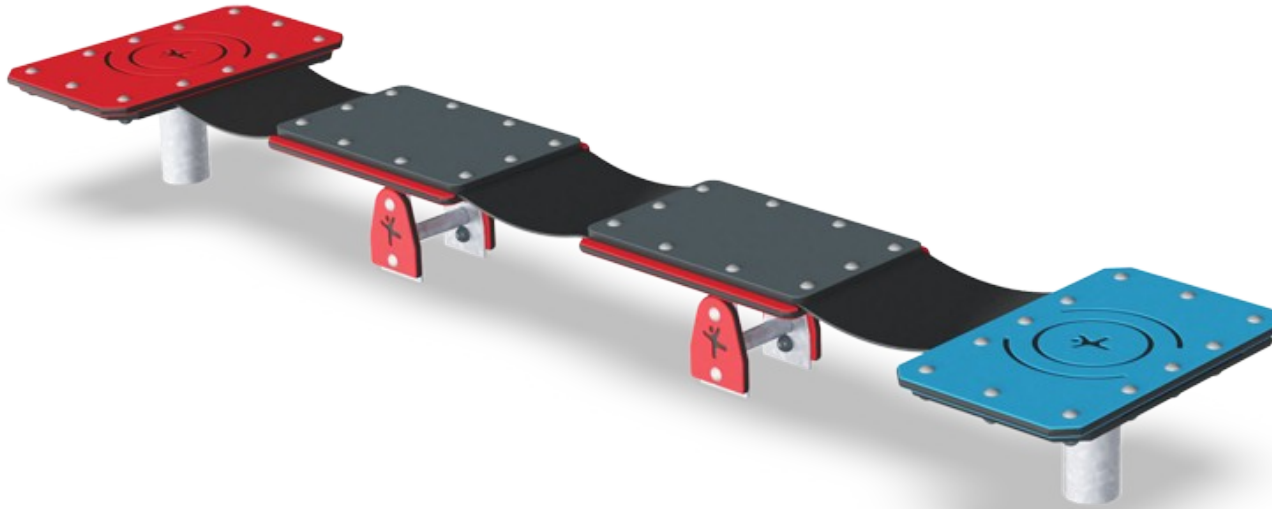

产品编号 CRP201201-0401

产品信息概览

长宽高尺寸	290x65x29 cm
适用年龄段	2+
容纳人数	4
颜色选择	



Wave Stepper 是一项绝佳的平衡游戏，吸引着孩子们，并鼓励他们反复玩耍。它能对孩子们的动作做出反应，给他们带来快感，并培养他们对因果关系的理解：当我在这里移动时，它也会随之移动。在 Wave Stepper 上行走或奔跑时，孩子们可以训练平衡感，这是一项基本的运动技能，也是发展其他所有技能的基础。例如，平衡感使儿童能够静坐并集中注意力。当孩子们在 Wave

Stepper 上一起玩耍时，他们的同理心、轮流技能和为他人考虑的能力也得以发展。360 度全开放设计让所有人都能在地面上进行社交互动。



Wave Stepper

CRP201201

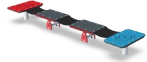

Wave Stepper

身体素质：训练平衡感，而平衡感是所有其他运动技能的基础，能让人自信、安全地在世界上行走。**社交情感：**在与他人擦肩而过和就座、站立、跳跃时，学会轮流技能和协商技巧。**认知能力：**当台阶随着儿童的动作略微倾斜时，有助于理解因果关系。

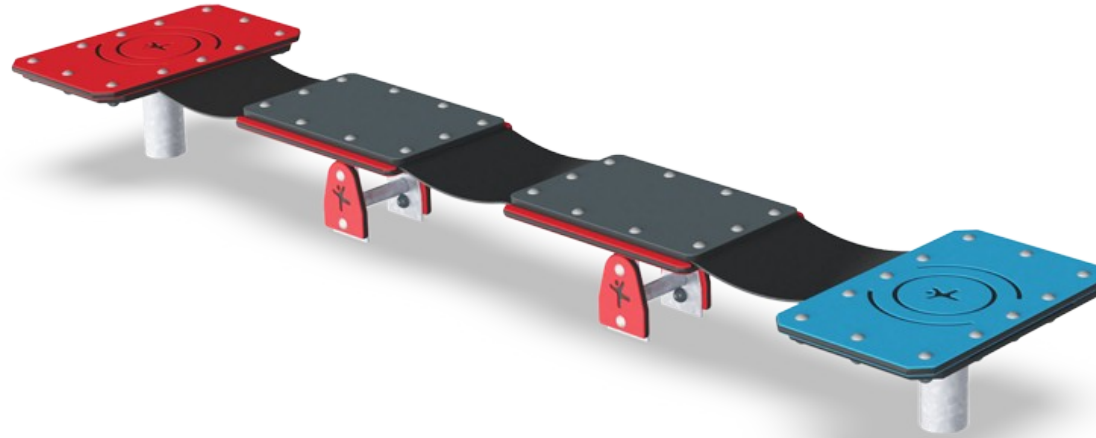

Wave Stepper

CRP201201



Corocord membranes consist of friction-proof rubberized material of conveyor belt quality with excellent UV resistance. Tested and compliant with REACH requirements for PAH. Embedded is a four-layered armoring made of woven polyester. The armoring and the two surface layers result in a total thickness of 8 mm.



Panels of 19mm EcoCore™. EcoCore™ is a highly durable, eco friendly material, which is not only recyclable after use, but also consists of material produced from +95% recycled post consumer material from food packing waste.



The two central plates on the Wave Stepper are of made of Ekogrip® panels that consist of a 15mm thick PE base with 3 mm top-layer of soft rubber with a non-skid effect.



The bushings are made of stainless steel or galvanized steel to ensures excellent shock absorption and durable connections with a high corrosion resistance.



钢表面内外均采用无铅热镀锌镀层，户外耐蚀性高，维护成本低。

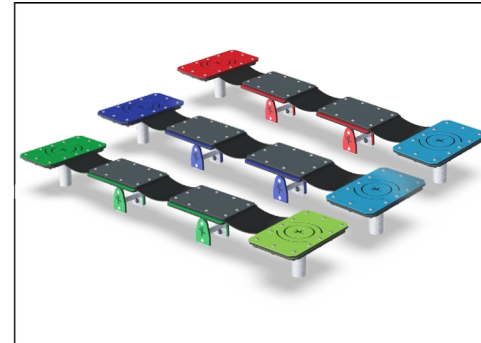

The Wave Stepper comes in three different iconic color concepts. But the Stepper can also be customized to your preferences and personalized with a variety of Kompan colors, for both the base plates and footing.

产品编号 CRP201201-0401

安装信息

最大跌落高度	28 cm
安全面积	19.3 m ²
安装总时长	4.9
开挖量	1.73 m ³
混凝土使用量	0.96 m ³
标准入地深度	90 cm
运输重量	132 kg
固定选项	入地 ✓

质保信息

EcoCore HDPE	终身质保
镀锌钢结构	终身质保
橡胶软膜	2 年
活动部件	2 年
承保零部件	10 年

**EN
1176**
compliant

Sustainability Data

CRP201201

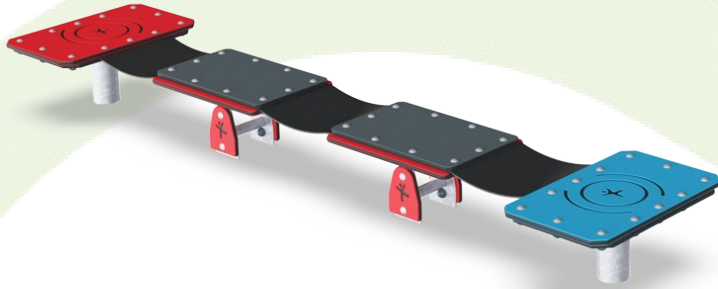

从原材料到成品

CO₂ 排放总量

kg CO₂e

CO₂ 排放量 / 千克

kg CO₂e/kg

回收的原料

%

CRP201201-0401

233.36

2.32

57.11

这些因素采用的总体框架为环保产品声明 (EPD), 该声明可量化“产品生命周期的环保信息, 并对相同功能的产品进行对比”(ISO, 2006)。在遵循该框架的同时, 对从原材料到制造的整个产品阶段 (A1-A3) 应用生命周期评估法。

Kompan A/S

C.F. Tietgens Boulevard 32C
DK-5220 Odense SØ
Denmark



Verification of CO₂ calculation of: Corocord

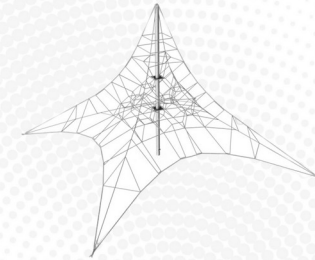

Data version no. 2023-10-05

The CO₂ calculation and data are in compliance with the principles of a carbon footprint impact according to the GHG protocol (Greenhouse Gas Protocol), Scope 3, cradle to gate related to all individual components in the product category: "Corocord" represented by item no.: COR314011-1101.

(Scope 3 emissions include emission sources in the upstream and downstream value chain).

Date: 30. October 2023 | Valid until: 30. October 2025

Verified by:

Julie Marie Vejsgaard Larsen, LCA & EPD Consultant

Verification based on report: Validation of CO₂ calculation of 9 categories of Kompan product line, version 1.0, prepared by: Bureau Veritas HSE, Denmark: Julie M. V. Larsen.

Publication date: 30. October 2023

By Bureau Veritas HSE
www.bureauveritas.dk
+45 7731 1000



Wave Stepper

CRP201201

最大跌落高度 | 总高度 | 安全区域

最大跌落高度 | 总高度

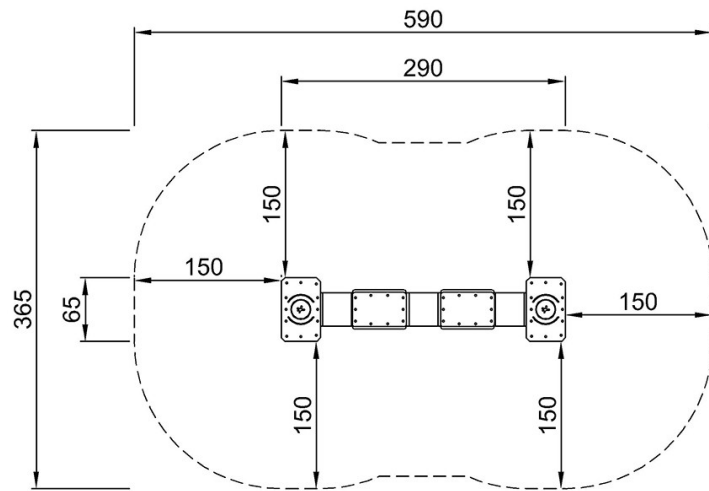

CRP201201
*28cm
**29cm
***19.3m²

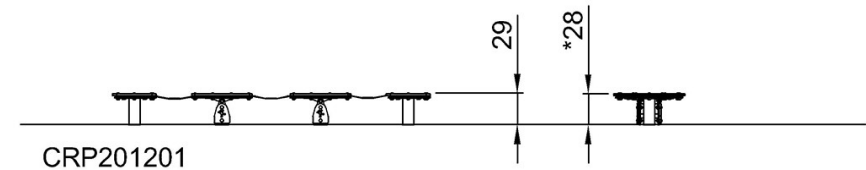

[点击查看俯视图](#)

[点击查看侧面图](#)