

# Play Chair, Red

MSV201



Item no. MSV20100-0001	
<b>General Product Information</b>	
Dimensions LxWxH	40x31x31 cm
Age group	1+
Play capacity (users)	1
Color options	



The Play Chair in red or yellow is a wonderfully attractive, multifunctional, and portable play item. Its many functions ensure that it is interesting for a long time: one side is a proper chair seat, the other side is a steeply grooved table, able to hold water, sand, and other construction materials, the third side is a more shallow groove, for instance for a teddy bear

bed. When placed at the high end, the Play Chair is a perfect stool for care givers who want to sit next to the play of the children. Last but not least, the Play Chair is a building block for the MOMENTS Toddler Supervised series of little infant and toddler play frames, fitting perfectly into their play through holes, like a chunky puzzle. Placed together in groups, the

Play Chairs makes for a cozy, multifunctional play corner that stimulates children's creativity in play.



*Data is subject to change without prior notice.*

# Play Chair, Red

MSV201



Play chair is made of low-density PE with excellent impact strength and usable within a large temperature span.

The Play chair is available in two different colour options.

Item no. MSV20100-0001

### Installation Information

Max. fall height	0 cm
Safety surfacing area	0.0 m <sup>2</sup>
Total installation time	0.6
Excavation volume	0.00 m <sup>3</sup>
Concrete volume	0.00 m <sup>3</sup>
Footing depth (standard)	0 cm
Shipment weight	4 kg
Anchoring options	Surface ✓

# Sustainability Data

MSV201



Cradle to Gate A1-A3	Total CO <sub>2</sub> emission	CO <sub>2</sub> e/kg	Recycled materials
	kg CO <sub>2</sub> e	kg CO <sub>2</sub> e/kg	%
<b>MSV20100-0001</b>	5.30	1.79	33.00

The overall framework applied for these factors is the Environmental Product Declaration (EPD), which quantifies "environmental information on the life cycle of a product and enable comparisons between products fulfilling the same function" (ISO, 2006). This follows the structure and applies a Life-Cycle Assessment approach to the entire Product stage from raw material through manufacturing (A1-A3))

**Kompan A/S**  
 C.F. Tietgens Boulevard 32C  
 DK-5220 Odense SØ  
 Denmark



## Verification of CO<sub>2</sub> calculation of: Themed play systems



Data version no. 2023-10-05

The CO<sub>2</sub> calculation and data are in compliance with the principles of a carbon footprint impact according to the GHG protocol (Greenhouse Gas Protocol), Scope 3, cradle to gate related to all individual components in the product category: "Themed play systems" represented by item no.: MSC641100-3717P.

(Scope 3 emissions include emission sources in the upstream and downstream value chain).

**Date: 30. October 2023 | Valid until: 30. October 2025**

Verified by:

Julie Marie Vejsgaard Larsen, LCA & EPD Consultant

Verification based on report: Validation of CO<sub>2</sub> calculation of 9 categories of Kompan product line, version 1.0, prepared by: Bureau Veritas HSE, Denmark: Julie M. V. Larsen.

**Publication date: 30. October 2023**

By Bureau Veritas HSE  
 www.bureauveritas.dk  
 +45 7731 1000



# Play Chair, Red

MSV201

\* Max fall height | \*\* Total height | \*\*\* Safety surfacing area

\* Max fall height | \*\* Total height

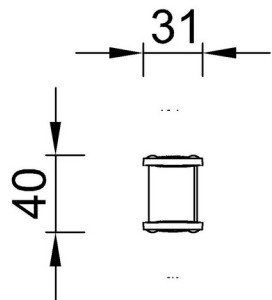

MSV20100-0002  
\*\*31cm

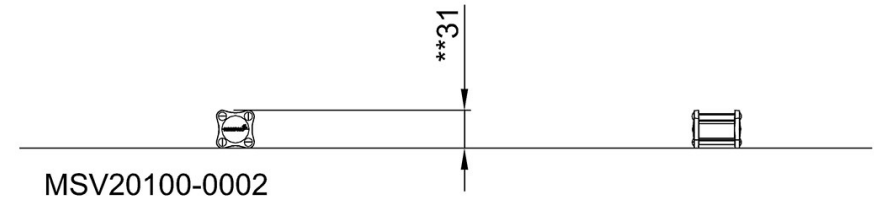

[Click to see TOP VIEW](#)

[Click to see SIDE VIEW](#)