

# Sitting Pole

NRO210



Item no. NRO210-0501

## General Product Information

Dimensions LxWxH	27x22x29 cm
Age group	1+
Play capacity (users)	1
Colour options	<input type="radio"/> <input checked="" type="radio"/>

Product is available as FSC® Certified (FSC® C004450) robinia wood on request.



# Sitting Pole

NRO210



## Pole seats

**Physical:** balancing and jumping from one seat to the next trains balance, proprioception and builds bone density. **Social-Emotional:** sharing, listening when having a break.



# Sitting Pole

NRO210



All Organic Robinia products by KOMPAN are made of Robinia wood from sustainable European sources. On request it can be supplied as FSC® Certified (FSC® C004450).

Item no. NRO210-0501	
<b>Installation Information</b>	
Max. fall height	29 cm
Safety surfacing area	8.5 m <sup>2</sup>
Total installation time	0.9
Excavation volume	0.07 m <sup>3</sup>
Concrete volume	0.00 m <sup>3</sup>
Footing depth (standard)	52 cm
Shipment weight	17 kg
Anchoring options	In-ground ✓ Surface ✓
<b>Warranty Information</b>	
Robinia wood	15 years
Spare parts guaranteed	10 years



# Sustainability Data

NRO210



Cradle to Gate A1-A3	Total CO <sub>2</sub> emission	CO <sub>2</sub> e/kg	Recycled materials
	kg CO <sub>2</sub> e	kg CO <sub>2</sub> e/kg	%
<b>NRO210-0501</b>	2.09	0.16	0.31

The overall framework applied for these factors is the Environmental Product Declaration (EPD), which quantifies "environmental information on the life cycle of a product and enable comparisons between products fulfilling the same function" (ISO, 2006). This follows the structure and applies a Life-Cycle Assessment approach to the entire Product stage from raw material through manufacturing (A1-A3))

**Kompan A/S**  
 C.F. Tietgens Boulevard 32C  
 DK-5220 Odense SØ  
 Denmark



## Verification of CO<sub>2</sub> calculation of: Nature play



Data version no. 2023-10-05

The CO<sub>2</sub> calculation and data are in compliance with the principles of a carbon footprint impact according to the GHG protocol (Greenhouse Gas Protocol), Scope 3, cradle to gate related to all individual components in the product category: "Nature play" represented by item no.: NRO409-0621.

(Scope 3 emissions include emission sources in the upstream and downstream value chain).

**Date: 30. October 2023 | Valid until: 30. October 2025**

**Verified by:**

Julie Marie Vejsgaard Larsen, LCA & EPD Consultant

Verification based on report: Validation of CO<sub>2</sub> calculation of 9 categories of Kompan product line, version 1.0, prepared by: Bureau Veritas HSE, Denmark: Julie M. V. Larsen.

**Publication date: 30. October 2023**

**By Bureau Veritas HSE**  
 www.bureauveritas.dk  
 +45 7731 1000



# Sitting Pole

NRO210

\* Max fall height | \*\* Total height | \*\*\* Safety surfacing area

\* Max fall height | \*\* Total height

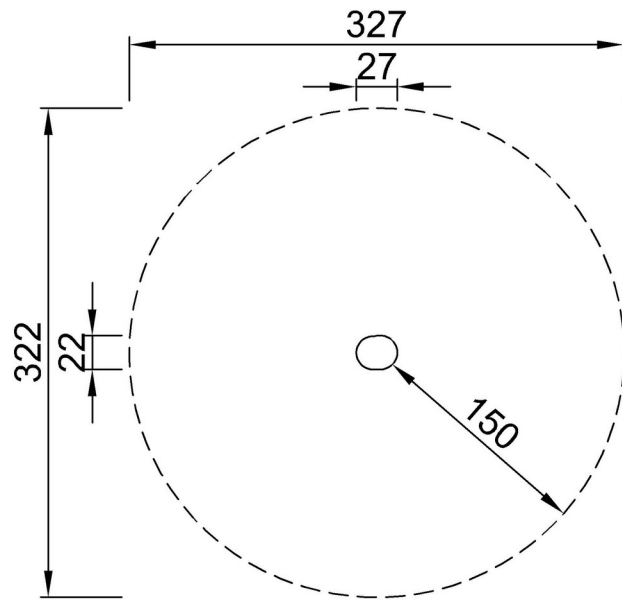

NRO210  
\*29cm  
\*\*29cm  
\*\*\*8.5m<sup>2</sup>

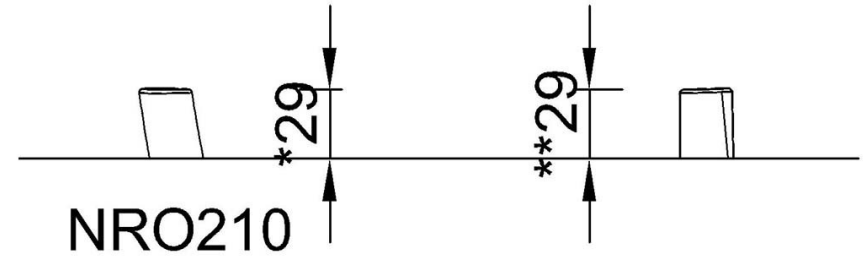

[Click to see TOP VIEW](#)

[Click to see SIDE VIEW](#)