

# Toddler Oasis with Sand Desk

NRO523

**KOMPAN**  
Let's play



This lovely Toddler Oasis with Sand Desk invites hours of explorative play with its sand sieve, sand scoop and little sand holders in the counter. All of these items, with their varied textures and functionalities provide great tactile stimulation for the little toddlers. They also learn about cause and effect, and learn social skills when using the bench to play with others.

The toddler oasis sits above the messy ground and is made of beautiful hand-crafted Robinia timber, which children can touch and feel and learn what natural timber is like.

Item no. NRO523-0621	
<b>General Product Information</b>	
Dimensions LxWxH	249x198x210 cm
Age group	1+
Play capacity (users)	6
Colour options	

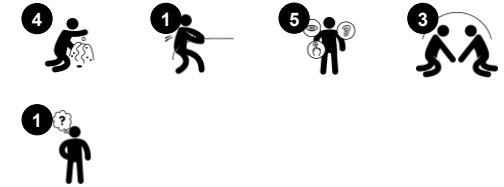

# Toddler Oasis with Sand Desk

NRO523



## Funnel

**Social-Emotional:** trains cooperation and turn-taking as children put materials into the funnel. **Cognitive:** the passing of materials through funnels supports the children's logical thinking and for younger children the understanding of object permanence: that materials don't vanish but run through at the other end.



## Sand desk with bowl and sieve

**Social-Emotional:** children can gather and store materials, cooperate and take a break together. **Creative:** sand can be shifted through the sieve, for understanding of 'cause and effect' and object permanence.



## Sand shovel

**Physical:** develops dexterity and upper body muscles. **Cognitive:** understanding of object permanence, emptying and filling scoop.



## Lower platform

**Physical:** climbing up and jumping down develops muscle and motor skills such as coordination, important in navigating your body securely through the world. **Social-Emotional:** children can sit and talk together. The step helps children who need extra height to maneuver the tap and water channel.

# Toddler Oasis with Sand Desk

NRO523



All organic Robinia products by KOMPAN are made of Robinia wood which is sourced from sustainable plantation farms. On request it can be supplied as FSC® Certified (FSC® C004450).

The product/activities are preassembled from the factory to ensure all safety requirements are considered.

The paint used for coloured components is water based, which is environmentally friendly and has excellent UV resistance. The paint complies with Australian Standards.

Item no. NRO523-0621	
Installation Information	
Max. fall height	28 cm
Safety surfacing area	22.6 m <sup>2</sup>
Total installation time	9.1
Excavation volume	0.46 m <sup>3</sup>
Concrete volume	0.04 m <sup>3</sup>
Footing depth (standard)	63 cm
Shipment weight	444 kg
Anchoring options	In-ground ✓
Warranty Information	
Robinia Wood	15 years
Ropes & Nets	10 years
Spare Parts Guarantee	10 years
Stainless Steel Components	Lifetime
Stainless Steel Components	Lifetime



The Robinia products come in a number of standard colour options. The wood can also be supplied as untreated or with brown painted with a pigment that maintains the wood colour.



# Sustainability Data

NRO523



Cradle to Gate A1-A3	Total CO <sub>2</sub> emission	CO <sub>2</sub> e/kg	Recycled materials
	kg CO <sub>2</sub> e	kg CO <sub>2</sub> e/kg	%
<b>NRO523-0621</b>	121.92	0.35	3.00

The overall framework applied for these factors is the Environmental Product Declaration (EPD), which quantifies "environmental information on the life cycle of a product and enable comparisons between products fulfilling the same function" (ISO, 2006). This follows the structure and applies a Life-Cycle Assessment approach to the entire Product stage from raw material through manufacturing (A1-A3))

**Kompan A/S**  
 C.F. Tietgens Boulevard 32C  
 DK-5220 Odense SØ  
 Denmark



## Verification of CO<sub>2</sub> calculation of: Nature play



Data version no. 2023-10-05

The CO<sub>2</sub> calculation and data are in compliance with the principles of a carbon footprint impact according to the GHG protocol (Greenhouse Gas Protocol), Scope 3, cradle to gate related to all individual components in the product category: "Nature play" represented by item no.: NRO409-0621.

(Scope 3 emissions include emission sources in the upstream and downstream value chain).

**Date: 30. October 2023 | Valid until: 30. October 2025**

Verified by:

Julie Marie Vejsgaard Larsen, LCA & EPD Consultant

Verification based on report: Validation of CO<sub>2</sub> calculation of 9 categories of Kompan product line, version 1.0, prepared by: Bureau Veritas HSE, Denmark: Julie M. V. Larsen.

**Publication date: 30. October 2023**

By Bureau Veritas HSE  
 www.bureauveritas.dk  
 +45 7731 1000



# Toddler Oasis with Sand Desk

NRO523

\* Max fall height | \*\* Total height | \*\*\* Safety surfacing area

\* Max fall height | \*\* Total height

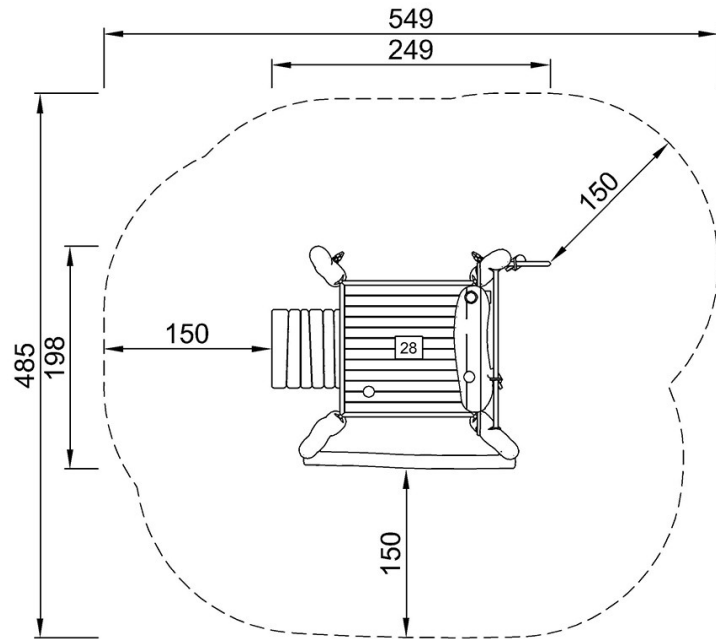

NRO523  
\*28cm  
\*\*210cm  
\*\*\*22.6m<sup>2</sup>

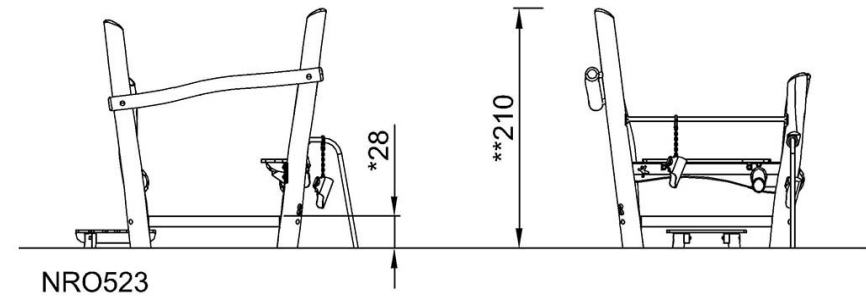

[Click to see TOP VIEW](#)

[Click to see SIDE VIEW](#)