



# Play Chair, Red

MSV201



Item no. MSV20100-0001	
General Product Information	
Dimensions LxWxH	40x31x31 cm
Age group	1+
Play capacity (users)	1
Colour options	 



The Play Chair in red or yellow is a wonderfully attractive, multifunctional, and portable play item. Its many functions ensure that it is interesting for a long time: one side is a proper chair seat, the other side is a steeply grooved table, able to hold water, sand, and other construction materials, the third side is a more shallow groove, for instance for a teddy bear

bed. When placed at the high end, the Play Chair is a perfect stool for care givers who want to sit next to the play of the children. Last but not least, the Play Chair is a building block for the MOMENTS Toddler Supervised series of little infant and toddler play frames, fitting perfectly into their play through holes, like a chunky puzzle. Placed together in groups, the

Play Chairs makes for a cozy, multifunctional play corner that stimulates children's creativity in play.



# Play Chair, Red

MSV201



## Play chair

**Physical:** muscle strength when handling and carrying. **Social-Emotional:** cooperation and turn-taking, choosing which side is up. Gathering, when placed more together.

**Cognitive:** finding out the diverse functionalities and shapes, especially when using this as a chunky puzzle. **Creative:** building new games when placed more together: sand play, gathering, putting teddy bears to bed, etc.



# Play Chair, Red

MSV201



Play chair is made of low-density PE with excellent impact strength and usable within a large temperature span.

The Play chair is available in two different colour options.

Item no. MSV20100-0001		
Installation Information		
Max. fall height	0 cm	
Safety surfacing area	0.0 m²	
Total installation time	0.6 hours	
Excavation volume	0.00 m³	
Concrete volume	0.00 m³	
Footing depth (standard)	0 cm	
Shipment weight	4 kg	
Anchoring options	Surface	✓
Warranty Information		
PE/PP components	5 years	
Spare parts guaranteed	10 years	

# Sustainability Data

MSV201



Cradle to Gate A1-A3	Total CO <sub>2</sub> emission	CO <sub>2</sub> e/kg	Recycled materials
	kg CO <sub>2</sub> e	kg CO <sub>2</sub> e/kg	%
MSV20100-0001	6.26	2.12	32.96

The overall framework applied for these factors is the Environmental Product Declaration (EPD), which quantifies "environmental information on the life cycle of a product and enable comparisons between products fulfilling the same function" (ISO, 2006). This follows the structure and applies a Life-Cycle Assessment approach to the entire Product stage from raw material through manufacturing (A1-A3))

**KOMPAN**  
Let's play

## Kompan A/S

C.F. Tietgens Boulevard 32C  
DK-5220 Odense SØ  
Denmark



## Verification of CO<sub>2</sub> calculation of: Themed play systems

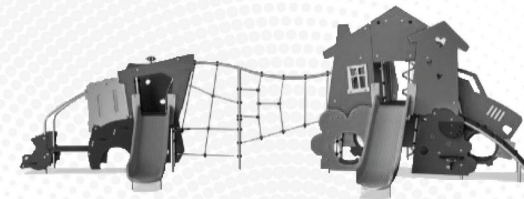

Data version no. 2023-10-05

The CO<sub>2</sub> calculation and data are in compliance with the principles of a carbon footprint impact according to the GHG protocol (Greenhouse Gas Protocol), Scope 3, cradle to gate related to all individual components in the product category: "Themed play systems" represented by item no.: MSC641100-3717P.

(Scope 3 emissions include emission sources in the upstream and downstream value chain).

**Date: 30. October 2023 | Valid until: 30. October 2025**

**Verified by:**

Julie Marie Vejsgaard Larsen, LCA & EPD Consultant

Verification based on report: Validation of CO<sub>2</sub> calculation of 9 categories of Kompan product line, version 1.0, prepared by: Bureau Veritas HSE, Denmark: Julie M. V. Larsen.

**Publication date: 30. October 2023**

By Bureau Veritas HSE  
www.bureauveritas.dk  
+45 7731 1000



# Play Chair, Red

MSV201

\* Max fall height | \*\* Total height | \*\*\* Safety surfacing area

\* Max fall height | \*\* Total height

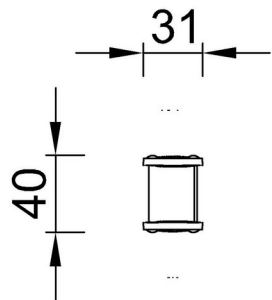

MSV20100-0002  
\*\*31cm

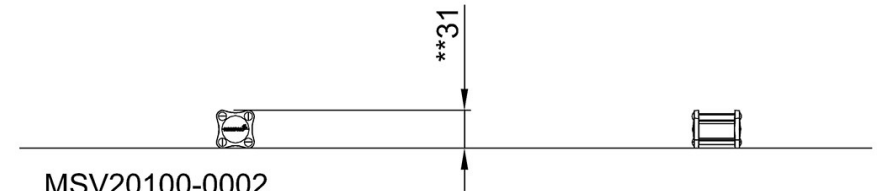

[Click to see TOP VIEW](#)

[Click to see SIDE VIEW](#)