

# Chicken Farm & Horse Carriage

MSC5426

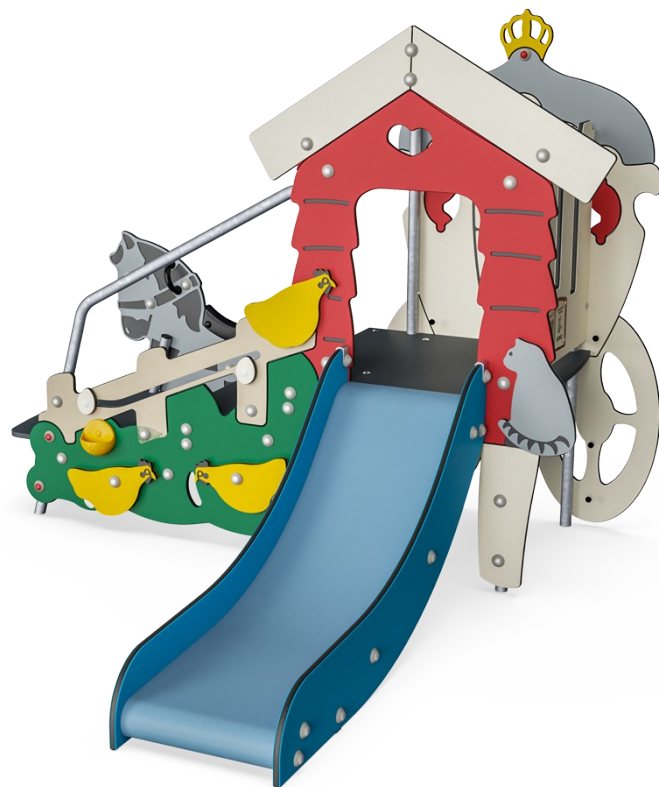

The Chicken Farm & Horse Carriage encourages toddlers to move their bodies and explore. The thrill of crawling up and sliding down is fun and it also trains the toddlers' cross-coordination and balance skills, fundamental to moving confidently in the world. The multitude of moveable sand scoops, eggs and hens that can tilt and reveal eggs, make

for great cognitive-creative play. Toddlers' logical thinking skills and language skills are intensely motivated by these tactile, themed elements. The Carriage side with horse is a fantastic meeting point. It adds to dramatic play and play stories. Taking turns sitting on the horse trains important social-emotional skills, fundamental in friendship building. The QR-

code additionally opens to a world of play stories and educational games around the stories of Hans Christian Andersen. Children will love spending hours playing on The Chicken Farm & Horse Carriage.

Item no. MSC542601-3417P	
<b>General Product Information</b>	
Dimensions LxWxH	209x216x166 cm
Age group	1+
Play capacity (users)	8
Colour options	

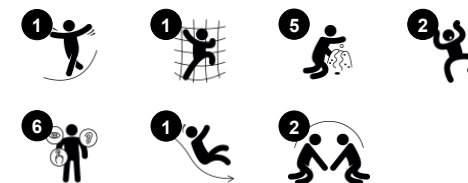

# Chicken Farm & Horse Carriage

MSC5426



## Theme

**Cognitive:** suggests a theme and supports dramatic play, which stimulates language and communication skills.

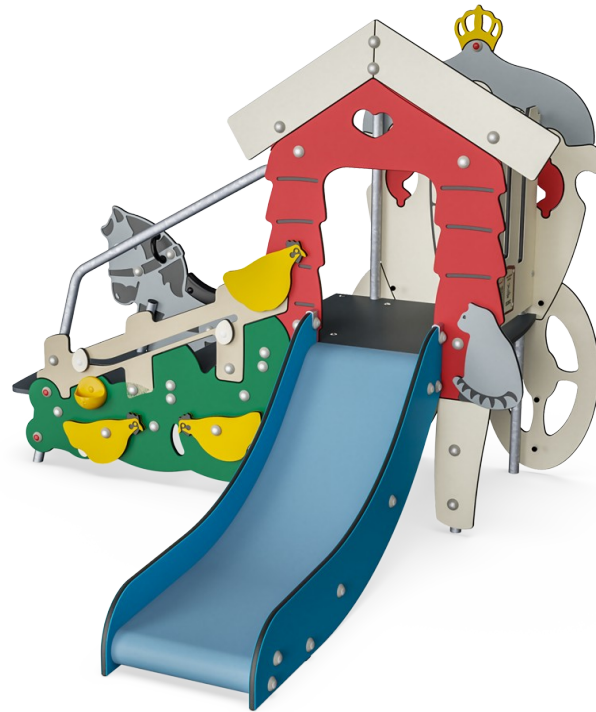

## Egg-laying hens

**Social-Emotional:** parallel play: two of the same activity. **Cognitive:** hand-eye coordination, cause and effect understanding and language skills are trained when tilting the hen to find the egg.



## Slide

**Physical:** develops spatial awareness, sense of balance and trains core muscles when sitting upright going down. **Social-Emotional:** empathy stimulated by turn-taking. **Cognitive:** young children develop their understanding of space, speed and distances when sliding down.

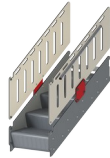

## Accessible stairway

**Physical:** climbing the accessible stairway is for all and supports cross coordination as well as arm and leg muscles. **Social-Emotional:** room for active breaks and adult helpers. An inclusive space.



## Play sphere

**Social-Emotional:** can be played from both sides, encouraging cooperation. **Cognitive:** cause and effect understanding. **Creative:** leave a mark and place the spheres at different positions.

# Chicken Farm & Horse Carriage

MSC5426



Panels of 19mm EcoCore™. EcoCore™ is a highly durable, eco-friendly material, which is not only recyclable after use but also consists of a core produced from 100% recycled material.



All floors are made from high-pressure laminate HPL with a thickness 17.8mm and non-skid surface texture. KOMPAN HPL is high wearing and suitable for all climates.



The slide is made of vacuum moulded PE, which is a high impact resistance across a wide temperature span which ensures vandal resistance in all locations.



Handholds are made of injection moulded high-quality nylon (PA6) which has good wearing and impact strength.

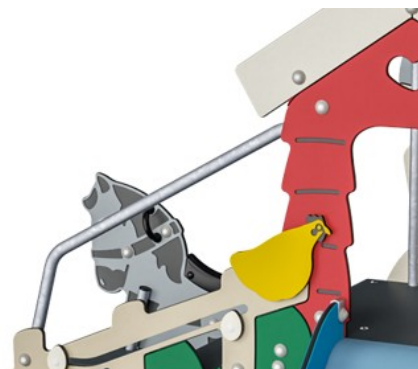

The steel surfaces are hot-dip galvanised inside and outside with lead-free zinc. The galvanisation has excellent corrosion resistance in outside environments and requires low maintenance.



Saddle is made of PUR. It retains its properties in the temperature range of -30°C to 60°C and the material is UV stabilised.

Item no. MSC542601-3417P

## Installation Information

Max. fall height	100 cm
Safety surfacing area	18.2 m <sup>2</sup>
Total installation time	10.9
Excavation volume	0.28 m <sup>3</sup>
Concrete volume	0.00 m <sup>3</sup>
Footing depth (standard)	60 cm
Shipment weight	201 kg
Anchoring options	In-ground ✓ Surface ✓

## Warranty Information

EcoCore HDPE	Lifetime
Galvanised Steel	Lifetime
HPL Decks	15 years
Ropes & Nets	10 years
Spare Parts Guarantee	10 years



# Sustainability Data

MSC5426



Cradle to Gate A1-A3	Total CO <sub>2</sub> emission	CO <sub>2</sub> e/kg	Recycled materials
	kg CO <sub>2</sub> e	kg CO <sub>2</sub> e/kg	%
<b>MSC542601-3417P</b>	277.41	1.84	57.42

The overall framework applied for these factors is the Environmental Product Declaration (EPD), which quantifies "environmental information on the life cycle of a product and enable comparisons between products fulfilling the same function" (ISO, 2006). This follows the structure and applies a Life-Cycle Assessment approach to the entire Product stage from raw material through manufacturing (A1-A3))

**Kompan A/S**  
 C.F. Tietgens Boulevard 32C  
 DK-5220 Odense SØ  
 Denmark



## Verification of CO<sub>2</sub> calculation of: Themed play systems



Data version no. 2023-10-05

The CO<sub>2</sub> calculation and data are in compliance with the principles of a carbon footprint impact according to the GHG protocol (Greenhouse Gas Protocol), Scope 3, cradle to gate related to all individual components in the product category: "Themed play systems" represented by item no.: MSC641100-3717P.

(Scope 3 emissions include emission sources in the upstream and downstream value chain).

**Date: 30. October 2023 | Valid until: 30. October 2025**

**Verified by:**

Julie Marie Vejsgaard Larsen, LCA & EPD Consultant

Verification based on report: Validation of CO<sub>2</sub> calculation of 9 categories of Kompan product line, version 1.0, prepared by: Bureau Veritas HSE, Denmark: Julie M. V. Larsen.

**Publication date: 30. October 2023**

**By Bureau Veritas HSE**  
 www.bureauveritas.dk  
 +45 7731 1000



# Chicken Farm & Horse Carriage

MSC5426

\* Max fall height | \*\* Total height | \*\*\* Safety surfacing area

\* Max fall height | \*\* Total height

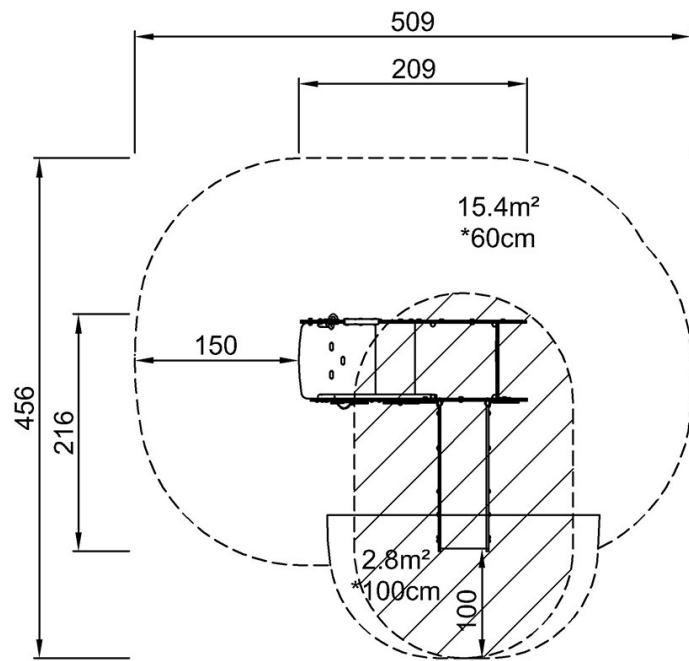

\*100cm  
\*\*166cm  
\*\*\*18.2m<sup>2</sup>



MSC542600

[Click to see TOP VIEW](#)

[Click to see SIDE VIEW](#)