

Seesaw, 2 persons

NRO10501

KOMPAN
Let's play



Item no. NRO10501-0501

General Product Information

Dimensions LxWxH	415x21x117 cm
Age group	4+
Play capacity (users)	2
Color options	 



시대를 초월한 놀이의 즐거움, Seesaw
Seesaw 는 오랜 세월 동안 많은 아이들을
매료시켜 온 놀이터의 클래식한 놀이기구입니
다. 높이 올라갔다가 빠르게 내려올 때 느낄 수
있는 스릴은 세대를 초월해 언제나 매력적인
요소입니다.
Seesaw 는 아이들의 공간 감각과 리듬감을
길러주고, 다리 근력을 발달시키는 데 도움을

줍니다. 이러한 운동 능력은 거리에서 시간과
움직임, 사물을 예측하는 등 아이들이 세상을
더욱 안전하게 탐색하는 데 중요한 역할을
합니다.
또한, 시소 놀이는 단순한 신체 활동을 넘어
사회적인 요소도 포함하고 있습니다. 친구와의
신뢰와 협력이 필수적인 놀이기구이기 때문에,
자연스럽게 차례를 지키는 법과 협력하는

능력을 배우게 됩니다. 다른 사람의 한계를
배려하는 공감 능력도 함께 길러집니다.
때로는 다른 친구들이 용기를 내 도전하는
모습을 보며, 스스로 새로운 시도를 해보려는
동기를 얻기도 합니다.
Seesaw 는 단순한 놀이기구가 아니라,
아이들에게 신체적·사회적 성장의 기회를
제공하는 소중한 공간입니다.

Seesaw, 2 persons

NRO10501

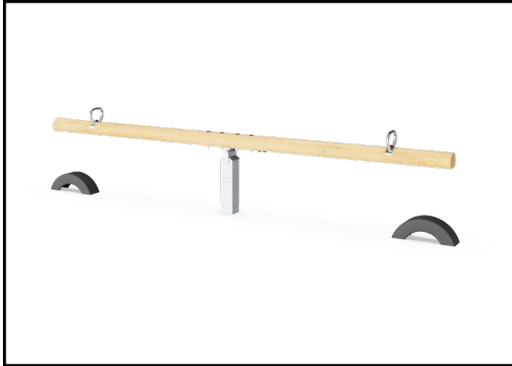

All Organic Robinia products by KOMPAN are made of Robinia wood from sustainable European sources. On request it can be supplied as FSC® Certified (FSC® C004450).



The Robinia wood can be supplied as untreated raw wood or painted with a brown coloured transparent pigment that maintains the golden wood colour of the wood.



The steel surfaces are hot dip galvanised inside and outside with lead free zinc. The galvanisation has excellent corrosion resistance in outside environments and requires low maintenance.

Item no. NRO10501-0501

Installation Information

Max. fall height	117 cm
Safety surfacing area	12.3 m²
Total installation time	2.9
Excavation volume	0.59 m³
Concrete volume	0.15 m³
Footing depth (standard)	70 cm
Shipment weight	129 kg
Anchoring options	Surface ✓ In-ground ✓

Warranty Information

Hot dip galvanised steel	Lifetime
Robinia wood	15 years
Spare parts guaranteed	10 years



Sustainability Data

NRO10501



Cradle to Gate A1-A3	Total CO ₂ emission	CO ₂ e/kg	Recycled materials
	kg CO ₂ e	kg CO ₂ e/kg	%
NRO10501-0501	66.22	0.61	32.38

The overall framework applied for these factors is the Environmental Product Declaration (EPD), which quantifies "environmental information on the life cycle of a product and enable comparisons between products fulfilling the same function" (ISO, 2006). This follows the structure and applies a Life-Cycle Assessment approach to the entire Product stage from raw material through manufacturing (A1-A3))

Kompan A/S

C.F. Tietgens Boulevard 32C
DK-5220 Odense SØ
Denmark



Verification of CO₂ calculation of: Nature play



Data version no. 2023-10-05

The CO₂ calculation and data are in compliance with the principles of a carbon footprint impact according to the GHG protocol (Greenhouse Gas Protocol), Scope 3, cradle to gate related to all individual components in the product category: "Nature play" represented by item no.: NRO409-0621.

(Scope 3 emissions include emission sources in the upstream and downstream value chain).

Date: 30. October 2023 | Valid until: 30. October 2025

Verified by:

Julie Marie Vejsgaard Larsen, LCA & EPD Consultant

Verification based on report: Validation of CO₂ calculation of 9 categories of Kompan product line, version 1.0, prepared by: Bureau Veritas HSE, Denmark: Julie M. V. Larsen.

Publication date: 30. October 2023

By Bureau Veritas HSE
www.bureauveritas.dk
+45 7731 1000



Seesaw, 2 persons

NRO10501

* Max fall height | ** Total height | *** Safety surfacing area

* Max fall height | ** Total height

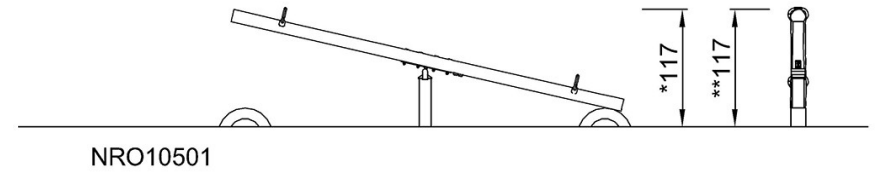
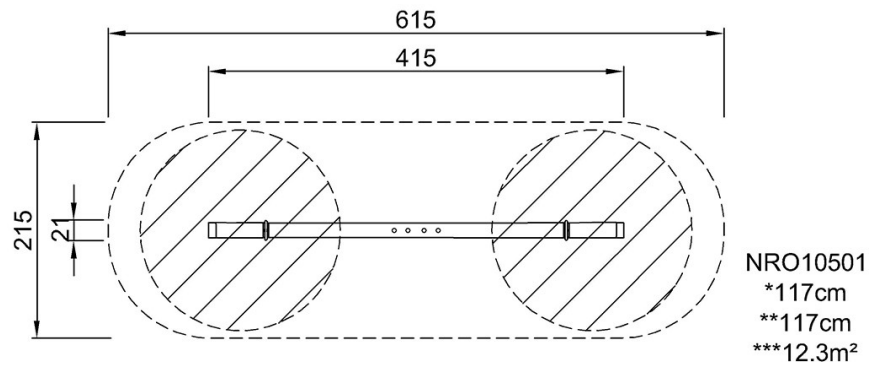

[Click to see TOP VIEW](#)

[Click to see SIDE VIEW](#)