

Green House & Florist

MSV604

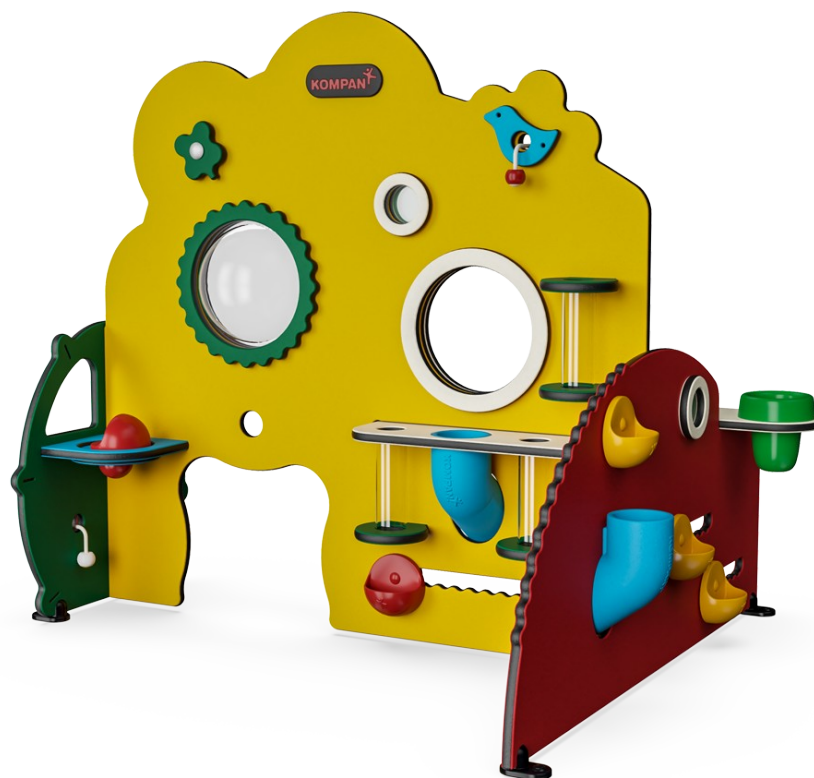

Item no. MSV60400-0201	
General Product Information	
Dimensions LxWxH	146x120x121 cm
Age group	6m+
Play capacity (users)	8
Colour options	

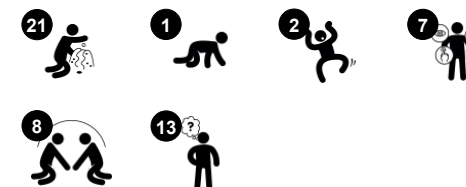

Children are attracted to the activity of the Green House & Florist. In a small space, children can't get enough participating. Loaded with play, the unit benefits the children's physical, social-emotional, cognitive, and creative development. Numerous play features encourage social play as they unite children with tangible, cross-panel play activities: the

tube, sand scoop, and string with a knob. The Green House & Florist has tangible themes: switch, bell, scoops making sounds when run in the toothed grooves, see-through flower vases. These scaffold logical thinking skills as children push, pull and investigate the numerous play items which stimulate the child's logical thinking skills. The rich themes inspire

dramatic play, which is phenomenal for language development: a main factor for learning, friendships, and life success.



Green House & Florist

MSV604



Funnel

Social-Emotional: trains cooperation and turn-taking as children put materials into the funnel. **Cognitive:** the passing of materials through funnels supports the children's logical thinking and for younger children the understanding of object permanence: that materials don't vanish but run through at the other end.

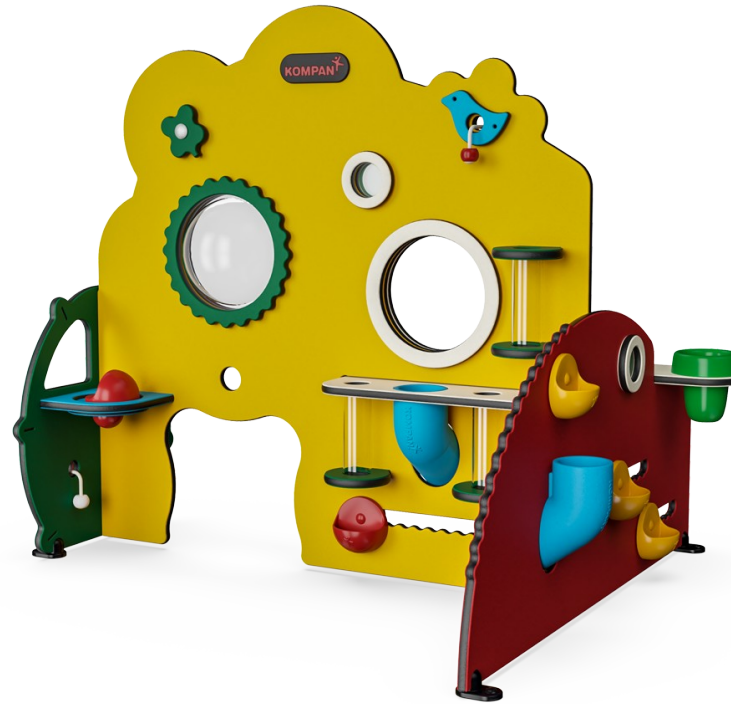

See-through tubes

Social-Emotional: the paired tubes invite parallel and cooperative play. **Cognitive:** shifting items through the tubes supports construction play and object permanence.

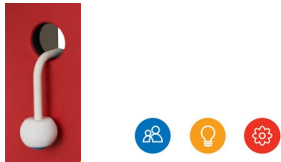

String with knobs

Social-Emotional: turn-taking and cooperation are supported when pulling the string from side to side with friends or caregiver. **Cognitive:** an understanding of object permanence is supported when the knob disappears and reappears when pulled. **Creative:** leaving the knob in different positions can support symbolic and creative thinking.



Bubble window

Social-Emotional: invites interaction between outside and inside. **Cognitive:** distorts the sound of the voice, developing logical thinking.

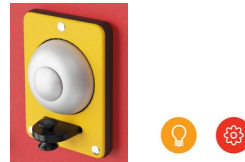

Bell

Cognitive: understanding cause and effect when ringing bell. **Creative:** leaving a mark in creating a sound rhythm when ringing or knocking the bell.



Pot

Cognitive: filling, removing and emptying the pot stimulates cause and effect understanding and logical thinking when empty or full. **Creative:** placing the pot in other areas of the play space in creative ways can support symbolic and creative thinking.



Sand scoops

Physical: hand eye coordination and push-pull movements. **Social-Emotional:** invites cooperation due to the two-sides and provides for parallel play. **Cognitive:** logical thinking: cause and effect, when running scoops in grooves or shifting materials between scoops. **Creative:** shifting scoops, creating new scoop positions.

Green House & Florist

MSV604



Panels of 19mm EcoCore™. EcoCore™ is a highly durable, eco-friendly material, which is not only recyclable after use but also consists of a core produced from 100% recycled material.

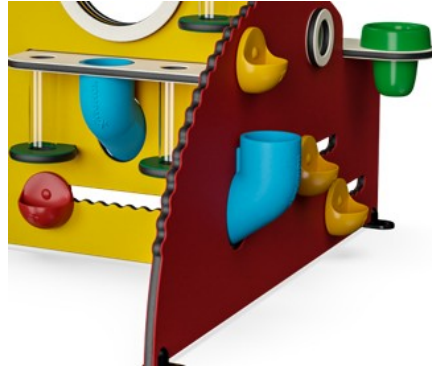

The sand pipe is made from rotomoulded PE, which is a durable material which is suitable for high-temperature span climates.



Pots are made of pressure moulded high-quality nylon (PA6) which has good wearing and impact strength.

Item no. MSV60400-0201

Installation Information

Max. fall height	0 cm
Safety surfacing area	14.9 m ²
Total installation time	5.1
Excavation volume	0.00 m ³
Concrete volume	0.00 m ³
Footing depth (standard)	0 cm
Shipment weight	52 kg
Anchoring options	Surface ✓

Warranty Information

EcoCore HDPE	Lifetime
Membrane	2 years
Movable Parts	2 years
PUR Components	10 years
Spare Parts Guarantee	10 years



On the side of the wall, there is a transparent bubble which is made from UV-stabilised PC.

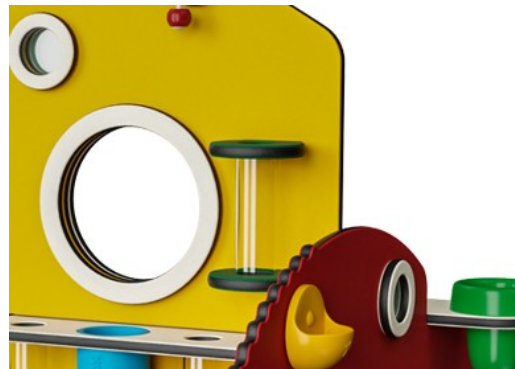

See-through tubes are made of PPMA, which is outstanding durability and resistance to UV radiation.



Sustainability Data

MSV604

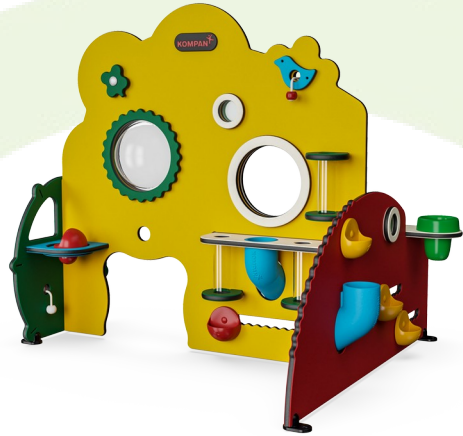

Cradle to Gate A1-A3	Total CO ₂ emission	CO ₂ e/kg	Recycled materials
	kg CO ₂ e	kg CO ₂ e/kg	%
MSV60400-0201	64.14	1.31	85.07

The overall framework applied for these factors is the Environmental Product Declaration (EPD), which quantifies "environmental information on the life cycle of a product and enable comparisons between products fulfilling the same function" (ISO, 2006). This follows the structure and applies a Life-Cycle Assessment approach to the entire Product stage from raw material through manufacturing (A1-A3))

Kompan A/S
 C.F. Tietgens Boulevard 32C
 DK-5220 Odense SØ
 Denmark



Verification of CO₂ calculation of: Themed play systems

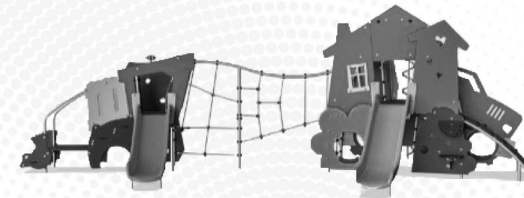

Data version no. 2023-10-05

The CO₂ calculation and data are in compliance with the principles of a carbon footprint impact according to the GHG protocol (Greenhouse Gas Protocol), Scope 3, cradle to gate related to all individual components in the product category: "Themed play systems" represented by item no.: MSC641100-3717P.

(Scope 3 emissions include emission sources in the upstream and downstream value chain).

Date: 30. October 2023 | Valid until: 30. October 2025

Verified by:

Julie Marie Vejsgaard Larsen, LCA & EPD Consultant

Verification based on report: Validation of CO₂ calculation of 9 categories of Kompan product line, version 1.0, prepared by: Bureau Veritas HSE, Denmark: Julie M. V. Larsen.

Publication date: 30. October 2023

By Bureau Veritas HSE
 www.bureauveritas.dk
 +45 7731 1000



Green House & Florist

MSV604

* Max fall height | ** Total height | *** Safety surfacing area

* Max fall height | ** Total height

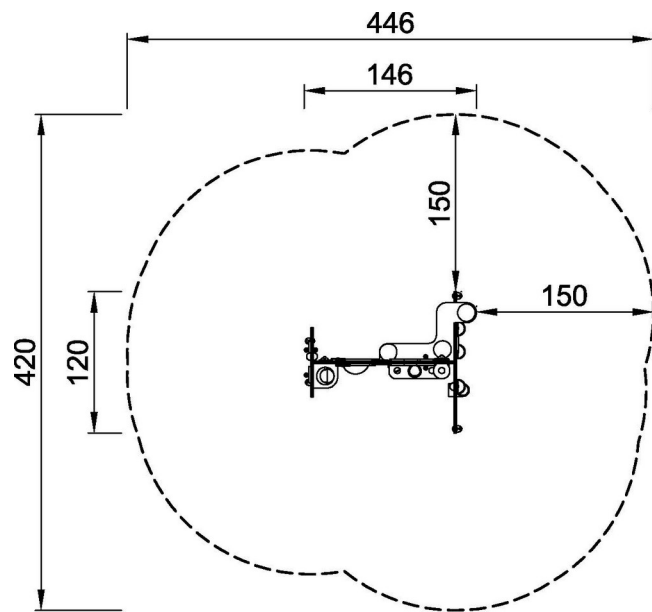

MSV60400-0201

**121cm
***14.9m²



MSV60400-0201

[Click to see TOP VIEW](#)

[Click to see SIDE VIEW](#)