

# Dress-Up Wall with Mirror

NRO603

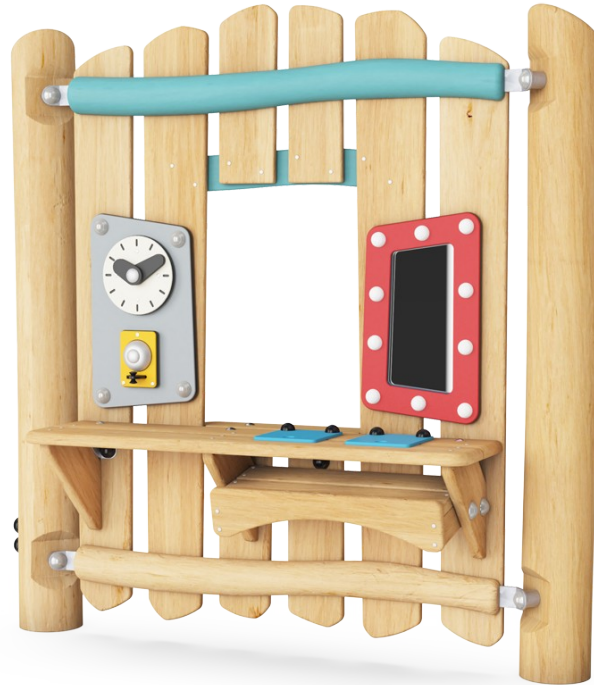

The Robinia Dress-Up wall with Mirror is a great play creator that invites numerous dramatic play scenarios: shop, beauty salon, kitchen. It repeatedly attracts children to play for a long time. The table with flaps covering holes and the shelf under the table make for endless play and experimenting, shifting materials through holes. This stimulates the

child's understanding of object permanence: that things can disappear from sight but still exist. This is fundamental for understanding that people exist even if you don't see them and thus is an important cognitive skill. The window, clock and bell invite hours of dramatic play. This is known to stimulate language development. The mirror builds up the child's

understanding of individuality and makes for hours of fun. The play panel encourages social interaction and cooperation in dramatic and explorative play.

Item no. NRO603-1021	
<b>General Product Information</b>	
Dimensions LxWxH	4'11"x0'7"x4'11"
Age group	2 - 5
Play capacity (users)	6
Color options	

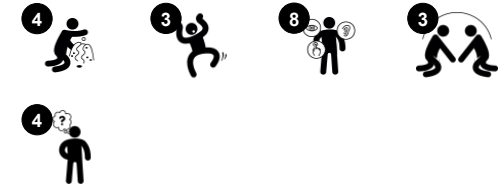

# Dress-Up Wall with Mirror

NRO603



## Mirror

**Cognitive:** understanding of individuality and self expression. Stimulates dramatic play and so language and communication development.

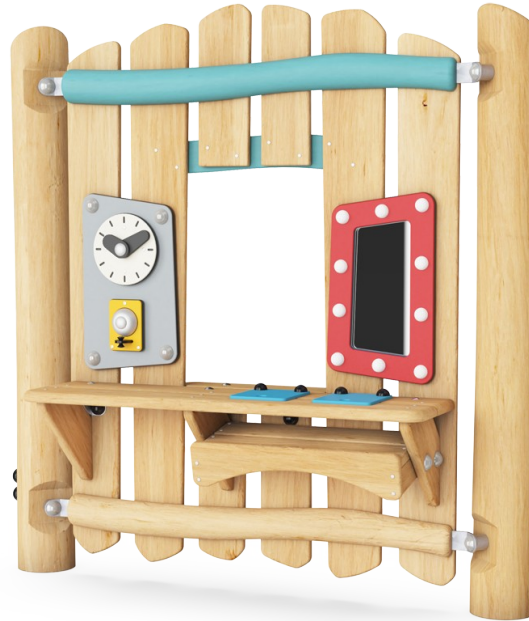

## Shelf

**Cognitive:** suggests a theme and supports dramatic play, which stimulates language and communication skills. Gives the option of hiding or storing items as part of dramatic play or explorative play.



## Desk flaps w. holes

**Social-Emotional:** cooperation, turn-taking and parallel play inspired by the two flaps.

**Cognitive:** shifting things through holes to shelf supports logical thinking and the understanding of object permanence.



## Window

**Social-Emotional:** invites interaction between sides and cooperative play.



## Clock and bell panel

**Cognitive:** understanding cause and effect when ringing bell, learning about numeracy and time in a tangible way. **Creative:** leaving a mark when creating new positions on clock or with sound creating a rhythm when ringing or knocking the bell.

# Dress-Up Wall with Mirror

NRO603



All Organic Robinia products by KOMPAN are made of Robinia wood from sustainable European sources. On request it can be supplied as FSC® Certified (FSC® C004450).



The paint used for colored components is water based environmental friendly with excellent UV resistance. The paint is in compliance with EN 71 Part 3.



Play activities in very strong materials: HDPE-plate with HDPE-clock and hands in conveyer belt rubber, bell in pressed aluminium. Mirror in plexi-glass with a high impact resistant.

Item no. NRO603-1021	
Installation Information	
Max. fall height	0'0"
Safety surfacing area	0ft <sup>2</sup>
Total installation time	5.5
Excavation volume	0.33yd <sup>3</sup>
Concrete volume	0yd <sup>3</sup>
Footing depth (standard)	3'3"
Shipment weight	314lbs
Anchoring options	In-ground ✓
Warranty Information	
Robinia Wood	10 Years
Spare Parts Availability	10 Years
Stainless steel components	Lifetime
Stainless steel components	Lifetime



All rubber activities/components are made of conveyer belt rubber that makes it extremely weather resistant and long lasting.

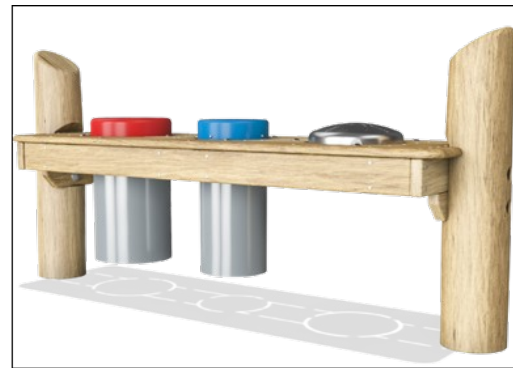

The percussion panel consist of 2 Conga Drums with PP tubes and top in colored ABS. Babel drum in stainless steel 316L.

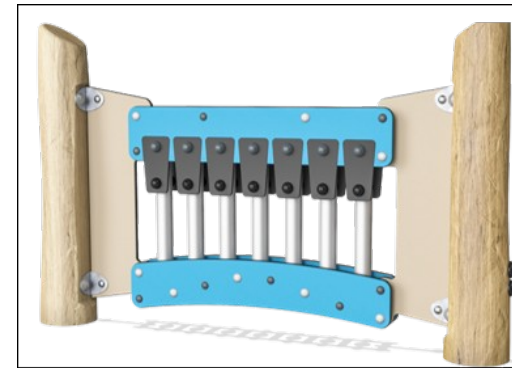

The Xylofon music panel consist of HDPE - material in 19mm EcoCore™. EcoCore™ is a highly durable, ecofriendly material. The pipes are made of die-cast aluminium specifically alloyed for outdoor environments.

Elevated activities 0	Accessible elevated activities	Accessible ground level activities	Accessible ground level play types
Present	0	1	1
Required	0	1	1

**ASTM  
F1487**  
compliant

# Sustainability Data

NRO603



Cradle to Gate A1-A3	Total CO <sub>2</sub> emission	CO <sub>2</sub> e/kg	Recycled materials
	kg CO <sub>2</sub> e	kg CO <sub>2</sub> e/kg	%
NRO603-1021	36.50	0.30	5.21

The overall framework applied for these factors is the Environmental Product Declaration (EPD), which quantifies "environmental information on the life cycle of a product and enable comparisons between products fulfilling the same function" (ISO, 2006). This follows the structure and applies a Life-Cycle Assessment approach to the entire Product stage from raw material through manufacturing (A1-A3))

**Kompan A/S**  
 C.F. Tietgens Boulevard 32C  
 DK-5220 Odense SØ  
 Denmark



## Verification of CO<sub>2</sub> calculation of: Nature play



Data version no. 2023-10-05

The CO<sub>2</sub> calculation and data are in compliance with the principles of a carbon footprint impact according to the GHG protocol (Greenhouse Gas Protocol), Scope 3, cradle to gate related to all individual components in the product category: "Nature play" represented by item no.: NRO409-0621.

(Scope 3 emissions include emission sources in the upstream and downstream value chain).

**Date: 30. October 2023 | Valid until: 30. October 2025**

**Verified by:**

Julie Marie Vejsgaard Larsen, LCA & EPD Consultant

Verification based on report: Validation of CO<sub>2</sub> calculation of 9 categories of Kompan product line, version 1.0, prepared by: Bureau Veritas HSE, Denmark: Julie M. V. Larsen.

**Publication date: 30. October 2023**

**By Bureau Veritas HSE**  
 www.bureauveritas.dk  
 +45 7731 1000





# Dress-Up Wall with Mirror

NRO603

\* Max fall height | \*\* Total height | \*\*\* Safety surfacing area

\* Max fall height | \*\* Total height

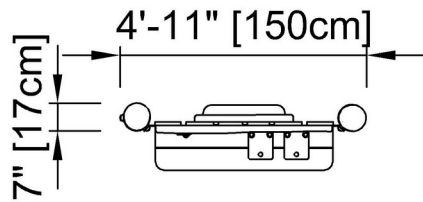

NRO603  
\*\* 4'-11" / 151cm

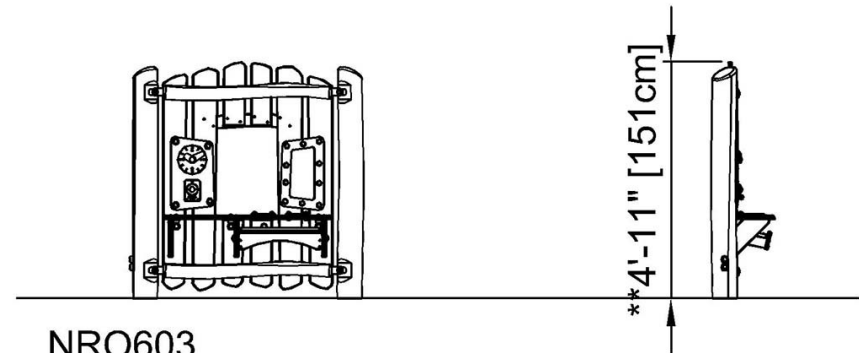

NRO603

[Click to see TOP VIEW](#)

[Click to see SIDE VIEW](#)