

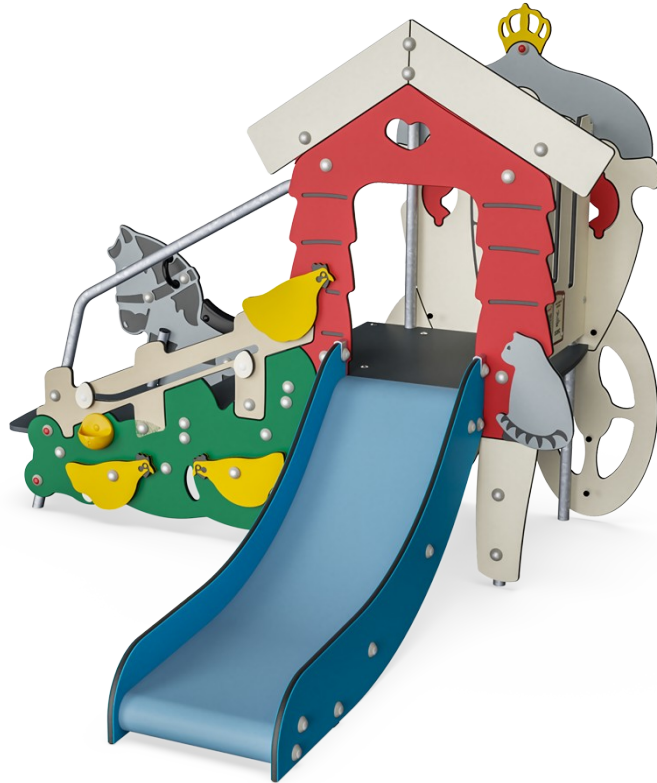

Chicken Farm & Horse Carriage

MSC5426



Item no. MSC542601-3417P	
General Product Information	
Dimensions LxWxH	209x216x166 cm
Age group	1+
Play capacity (users)	8
Colour options	

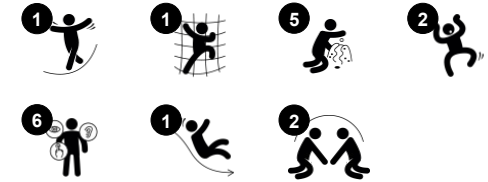

Role play encouraged by the Chicken farm and Horse Carriage, themes that are familiar and open to a bigger world of fairy tales and many items to name, report and compare. There cannot be too many little fun details to discover for the children and these are made with a high degree of discovery; items that can be shifted, turned and opened to discover new items.

Chicken Farm & Horse Carriage

MSC5426



Theme

Cognitive: suggests a theme and supports dramatic play, which stimulates language and communication skills.

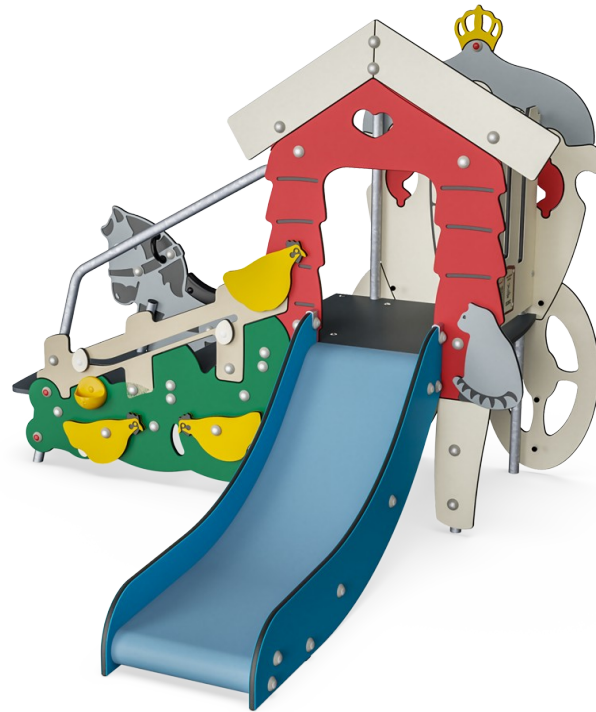

Slide

Physical: sliding develops spatial awareness and a sense of balance. Furthermore, the core muscles are trained when sitting upright going down. **Social-Emotional:** empathy stimulated by turn-taking. **Cognitive:** young children develop their understanding of space, speed and distances when sliding down quickly.

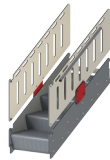

Accessible stairway

Physical: climbing the accessible stairway is for all and supports cross coordination as well as arm and leg muscles. For young children, walking stairs and alternating feet is developed. **Social-Emotional:** room for active breaks and adult helpers. An inclusive space.



Egg-laying hens

Social-Emotional: parallel play: two of same activity. **Cognitive:** hand-eye coordination. cause and effect understanding and language skills are trained when tilting the hen and finding the egg.



Play sphere

Social-Emotional: can be played from both sides, encouraging cooperation. **Cognitive:** cause and effect understanding. **Creative:** leave a mark and place the spheres at different positions.

Chicken Farm & Horse Carriage

MSC5426



Panels of 19mm EcoCore™. EcoCore™ is a highly durable, eco friendly material, which is not only recyclable after use, but also consists of material produced from +95% recycled post consumer material from food packing waste.



All floors are made of High-Pressure Laminate HPL with a thickness 17.8mm and non skid surface texture according to EN 438-6. KOMPAN HPL has high wearing strength to ensure long lifetime in all climates.



The slide is made of vacuum moulded PE. PE has high impact resistance across a wide temperature span which ensures vandal resistance in all locations.

Item no. MSC542601-3417P

Installation Information

Max. fall height	100 cm
Safety surfacing area	18.2 m ²
Total installation time	10.9
Excavation volume	0.28 m ³
Concrete volume	0.00 m ³
Footing depth (standard)	60 cm
Shipment weight	201 kg
Anchoring options	In-ground ✓ Surface ✓

Warranty Information

EcoCore HDPE	Lifetime
Hot dip galvanised steel	Lifetime
HPL decks	15 years
Ropes & nets	10 years
Spare parts guaranteed	10 years



Handholds are made of injection moulded high quality nylon (PA6). PA6 has good wearing and impact strength.

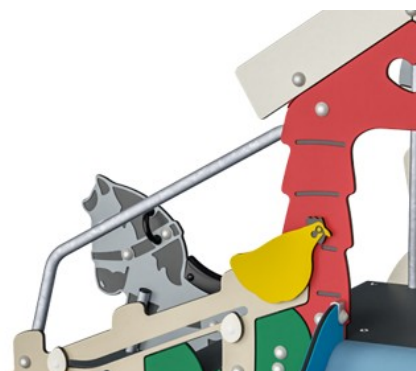

The steel surfaces are hot dip galvanised inside and outside with lead free zinc. The galvanisation has excellent corrosion resistance in outside environments and requires low maintenance.



Saddle is made of PUR. It retains its properties in the temperature range of -30°C to 60°C. Material is UV stabilised.



Sustainability Data

MSC5426



Cradle to Gate A1-A3	Total CO ₂ emission	CO ₂ e/kg	Recycled materials
	kg CO ₂ e	kg CO ₂ e/kg	%
MSC542601-3417P	277.41	1.84	57.42

The overall framework applied for these factors is the Environmental Product Declaration (EPD), which quantifies "environmental information on the life cycle of a product and enable comparisons between products fulfilling the same function" (ISO, 2006). This follows the structure and applies a Life-Cycle Assessment approach to the entire Product stage from raw material through manufacturing (A1-A3))

Kompan A/S
 C.F. Tietgens Boulevard 32C
 DK-5220 Odense SØ
 Denmark



Verification of CO₂ calculation of: Themed play systems



Data version no. 2023-10-05

The CO₂ calculation and data are in compliance with the principles of a carbon footprint impact according to the GHG protocol (Greenhouse Gas Protocol), Scope 3, cradle to gate related to all individual components in the product category: "Themed play systems" represented by item no.: MSC641100-3717P.

(Scope 3 emissions include emission sources in the upstream and downstream value chain).

Date: 30. October 2023 | Valid until: 30. October 2025

Verified by:

Julie Marie Vejsgaard Larsen, LCA & EPD Consultant

Verification based on report: Validation of CO₂ calculation of 9 categories of Kompan product line, version 1.0, prepared by: Bureau Veritas HSE, Denmark: Julie M. V. Larsen.

Publication date: 30. October 2023

By Bureau Veritas HSE
 www.bureauveritas.dk
 +45 7731 1000



Chicken Farm & Horse Carriage

MSC5426

* Max fall height | ** Total height | *** Safety surfacing area

* Max fall height | ** Total height

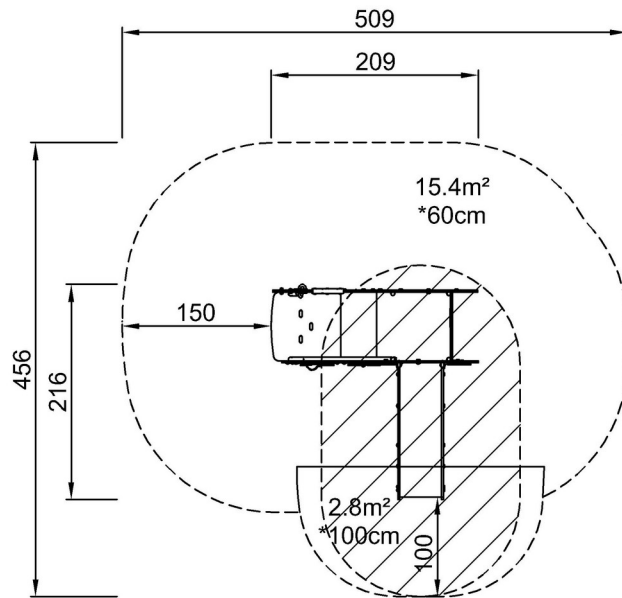

MSC542600
*100cm
**166cm
***18.2m²

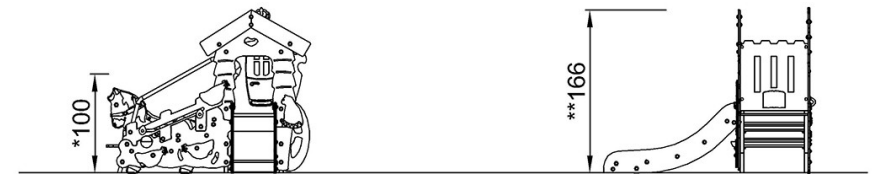

MSC542600

[Click to see TOP VIEW](#)

[Click to see SIDE VIEW](#)