

Outdoor Play Timer

PCM201

KOMPAN
Let's play



产品编号 PCM201-0901

产品信息概览

长宽高尺寸	44x23x127 cm
适用年龄段	5+
容纳人数	4
颜色选择	●



Play Timer 的倒计时声音和计时器按钮深深吸引着各个年龄段的儿童。Play Timer 可以测量自己的能力，或者和朋友之间相互比较，这本身就是一种游戏方式，让孩子们一次又一次地使用 Play Timer，不断返回到更多的游戏中。Play Timer 的开发过程以 KOMPAN 游戏研究中心对刺激性游戏的研究成果为基础。研究中心指出，与时间赛跑对年龄较大的儿童来说是一个重要的

刺激因素。Play Timer 除了能让孩子们在游戏中快乐地计时，比如在一段时间内走了多远，谁先到终点等，还能作为一个实用的轮流计时助手，为 10 秒、30 秒、2 分钟或 5 分钟的时间长度计时。对教师来说，这是一种让孩子们在不发生冲突的情况下进行轮流游戏的有趣而又轻松的方式。Play Timer 可以提高游戏的强度，加强合作，帮助孩子们学会互相关注。



Outdoor Play Timer

PCM201

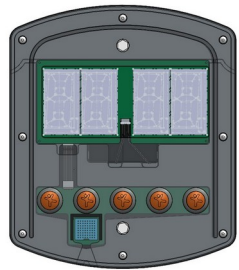

The reflective LCD display has four digits of 100mm height, with excellent outdoor visibility and a wide viewing angle. An LCD display has a low energy consumption, It is powered by 8 replaceable AA batteries with a lifespan of more than 2 years.

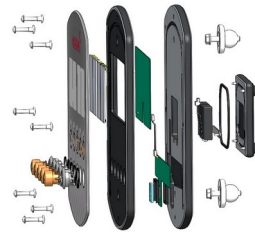

Front panels are made of UV-stabilized Polycarbonate. The UV-stabilization prevents the Transparent panels in being yellow over time and ensures the mechanical performances. The graphic prints are added by a unique multi-layer print process where the inner layer is the image and outer transparent layer functions as protection. The lacquer is water-based, and UV stabilized to prevent fading.



The push buttons and the housing for the push buttons are made from Polyamide (PA6). The buttons contain a magnet which activates a contactless reed switch when the buttons are pushed. This ensures high durability of the system.



The connectors are made of die-cast aluminum specially alloyed for outdoor environments and with a lead content below 100ppm. The connectors are attached to the posts by stainless steel screws and well protected against corrosion by special designed zinc washers. Extremely strong and no change of corrosion.

The loudspeaker is a piezoelectric speaker with a sound level of 90dB, and low power consumption. As power source we use eight standard AA 1,5V replaceable batteries with a capacity of 2.95Ah. The expected lifetime of the batteries is two years, depending on usage. It is recommended to inspect the batteries yearly. The batteries are placed in two sealed battery boxes with a protection class of IP65.



Steel posts are made of Ø101,6 x 2,0mm pre-galvanized steel tube. The posts are powder coated. Tops of posts are sealed with plastic caps (PA6). Footings for surface installation are manufactured from Carbon steel with hot-dip galvanized surface according to ISO1461.

产品编号 PCM201-0901

安装信息

最大跌落高度	0 cm
安全面积	9.6 m ²
安装总时长	2.4
开挖量	0.03 m ³
混凝土使用量	0.01 m ³
标准入地深度	85 cm
运输重量	37 kg
固定选项	入地 ✓ 地表 ✓

质保信息

聚碳酸酯 PC 面板	10 年
立柱	10 年
承保零部件	10 年



Sustainability Data

PCM201



从原材料到成品

CO₂ 排放总量

CO₂ 排放量 / 千克

回收的原料

kg CO₂e

kg CO₂e/kg

%

PCM201-0901

65.32

2.85

59.16

这些因素采用的总体框架为环保产品声明 (EPD), 该声明可量化“产品生命周期的环保信息, 并对相同功能的产品进行对比” (ISO, 2006)。在遵循该框架的同时, 对从原材料到制造的整个产品阶段 (A1-A3) 应用生命周期评估法。

Kompan A/S

C.F. Tietgens Boulevard 32C
DK-5220 Odense SØ
Denmark



Verification of CO₂ calculation of:
Park

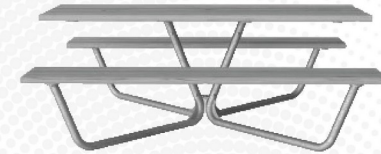

Data version no. 2023-10-05

The CO₂ calculation and data are in compliance with the principles of a carbon footprint impact according to the GHG protocol (Greenhouse Gas Protocol), Scope 3, cradle to gate related to all individual components in the product category: "Park" represented by item no.: PAR4070-0001.

(Scope 3 emissions include emission sources in the upstream and downstream value chain).

Date: 30. October 2023 | Valid until: 30. October 2025

Verified by:

Julie Marie Vejsgaard Larsen, LCA & EPD Consultant

Verification based on report: Validation of CO₂ calculation of 9 categories of Kompan product line, version 1.0, prepared by: Bureau Veritas HSE, Denmark: Julie M. V. Larsen.

Publication date: 30. October 2023

By Bureau Veritas HSE
www.bureauveritas.dk
+45 7731 1000



Outdoor Play Timer

PCM201

最大跌落高度 | 总高度 | 安全区域

最大跌落高度 | 总高度

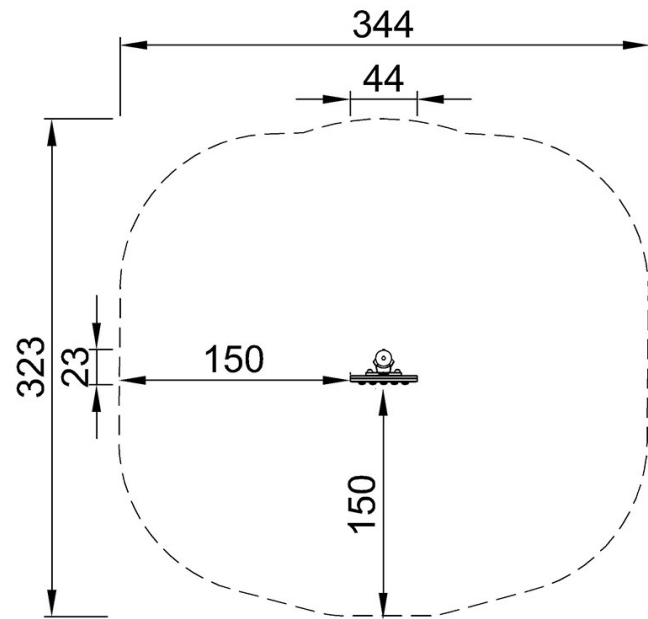

PCM201
**127cm
***9.6m²



PCM201

[点击查看俯视图](#)

[点击查看侧面图](#)