

# Forest Giraffe

MSC5416



Item no. MSC541600-3417P	
General Product Information	
Dimensions LxWxH	181x115x136 cm
Age group	6m+
Play capacity (users)	11
Colour options	



The Forest Giraffe is the friendliest animal on the savanna. It immediately attracts young children and with a wide variety of activities, toddlers can play for a long time and want to come back again and again. Thanks to the transparency in design and the wide platform, supporting children's play is easy for carers. The climbing net assists cross-coordination

and proprioception (sense of self-movement and body position), both fundamental motor skills in navigating the world securely. The nice den under the green platform has varied entry points to evoke the sense of wonder and logical thinking of space and measures in the child: Can I get through these openings? What shape are they? The rich tactile details are

lovely to touch and take toddlers on a journey of understanding e.g. object permanence: pulling the tail back and forth shows that things can disappear but still exist.



# Forest Giraffe

MSC5416



## Tail

**Social-Emotional:** cooperation and turn-taking when pulling the tail. **Cognitive:** understanding of object permanence: things can disappear without being gone forever. **Creative:** leaving a mark by placing the tail in your preferred position.



## Climbing net

**Physical:** hand-eye coordination, cross coordination and proprioception are trained. These are fundamental for judging the body in time and space.



## Flaps

**Cognitive:** hand eye coordination, exploring that some flaps have holes behind them, while some don't. This supports sense of wonder.



## Broad table platform

**Physical:** cross coordination and spatial awareness when crawling over and under. This trains secure navigation of space. **Social-Emotional:** space for meeting, resting and socializing. **Cognitive:** dark green horizontal panel and the sand colored vertical panels support the understanding of space.



## Play spheres with toothed grooves

**Social-Emotional:** can be played from both sides, encouraging cooperation. **Cognitive:** cause and effect understanding. **Creative:** leave a mark and place the spheres at different positions.



## Den

**Physical:** crawling through the possible openings trains spatial awareness. **Social-Emotional:** the enclosed space invites social play for two or three children. **Cognitive:** the holes invites naming and exploring shapes, supporting the understanding of shapes, space and measures.



## Crawl-through hole with curtains

**Physical:** the hole allows for climbing and crawling through, developing cross coordination and proprioception and spatial awareness. **Social-Emotional:** cooperation and turn-taking when playing with friends on the other side. **Cognitive:** understanding of object permanence: things can disappear without being gone forever – a thrilling insight.

# Forest Giraffe

MSC5416



Panels of 19mm EcoCore™. EcoCore™ is a highly durable, eco-friendly material, which is not only recyclable after use but also consists of a core produced from 100% recycled material.



Climbing nets are made of UV-stabilised PP rope with inner steel cable reinforcement. The rope is induction treated to obtain maximum fixation between steel and rope, which provides excellent wear and tear resistance. All rope connectors are made of 100% recyclable PA material.



The steel surfaces are hot-dip galvanised inside and outside with lead-free zinc. The galvanisation has excellent corrosion resistance in outside environments and requires low maintenance.

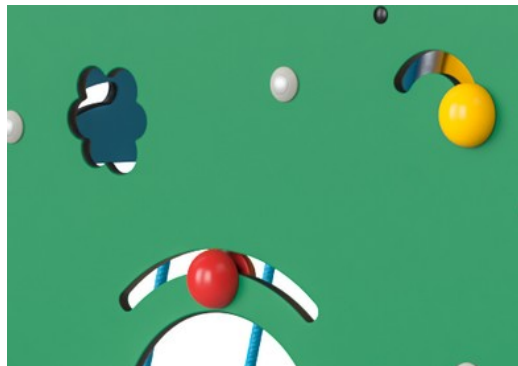

Play activities like the play sphere are made of injection moulded high-quality UV-stabilised nylon (PA6). Nylon has good wearing and impact strength.

Item no. MSC541600-3417P	
Installation Information	
Max. fall height	56 cm
Safety surfacing area	17.2 m <sup>2</sup>
Total installation time	7.6
Excavation volume	0.22 m <sup>3</sup>
Concrete volume	0.00 m <sup>3</sup>
Footing depth (standard)	60 cm
Shipment weight	143 kg
Anchoring options	In-ground ✓ Surface ✓
Warranty Information	
EcoCore HDPE	Lifetime
Galvanised Steel	Lifetime
Movable Parts	2 years
Ropes & Nets	10 years
Spare Parts Guarantee	10 years



# Sustainability Data

MSC5416



Cradle to Gate A1-A3	Total CO <sub>2</sub> emission	CO <sub>2</sub> e/kg	Recycled materials
	kg CO <sub>2</sub> e	kg CO <sub>2</sub> e/kg	%
<b>MSC541600-3417P</b>	140.60	1.56	78.79

The overall framework applied for these factors is the Environmental Product Declaration (EPD), which quantifies "environmental information on the life cycle of a product and enable comparisons between products fulfilling the same function" (ISO, 2006). This follows the structure and applies a Life-Cycle Assessment approach to the entire Product stage from raw material through manufacturing (A1-A3))

**Kompan A/S**  
 C.F. Tietgens Boulevard 32C  
 DK-5220 Odense SØ  
 Denmark



## Verification of CO<sub>2</sub> calculation of: Themed play systems



Data version no. 2023-10-05

The CO<sub>2</sub> calculation and data are in compliance with the principles of a carbon footprint impact according to the GHG protocol (Greenhouse Gas Protocol), Scope 3, cradle to gate related to all individual components in the product category: "Themed play systems" represented by item no.: MSC641100-3717P.

(Scope 3 emissions include emission sources in the upstream and downstream value chain).

**Date: 30. October 2023 | Valid until: 30. October 2025**

Verified by:

Julie Marie Vejsgaard Larsen, LCA & EPD Consultant

Verification based on report: Validation of CO<sub>2</sub> calculation of 9 categories of Kompan product line, version 1.0, prepared by: Bureau Veritas HSE, Denmark: Julie M. V. Larsen.

**Publication date: 30. October 2023**

By Bureau Veritas HSE  
 www.bureauveritas.dk  
 +45 7731 1000



# Forest Giraffe

MSC5416

\* Max fall height | \*\* Total height | \*\*\* Safety surfacing area

\* Max fall height | \*\* Total height

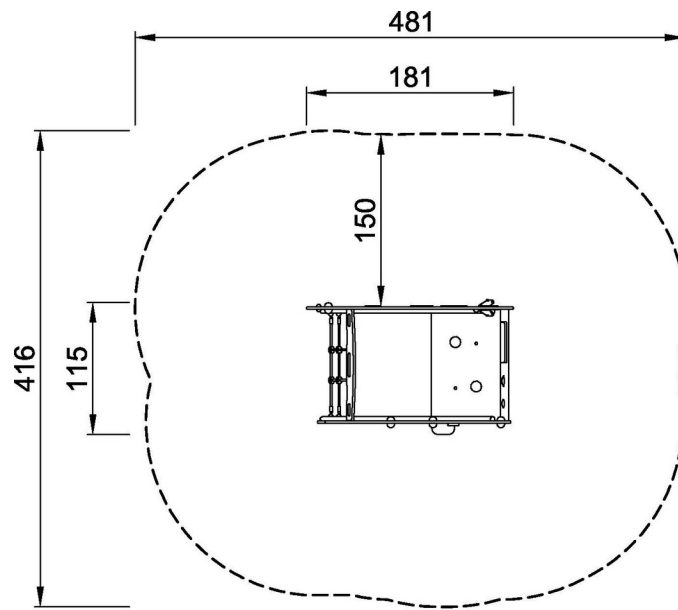

MSC541600P  
\*56cm  
\*\*136cm  
\*\*\*17.2m<sup>2</sup>

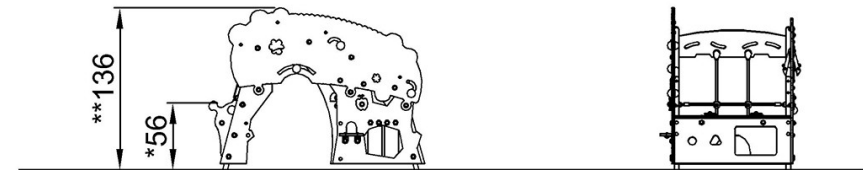

MSC541600P

[Click to see TOP VIEW](#)

[Click to see SIDE VIEW](#)